

Circulation 600

Boca Ciega Bay



Jungle Terrace Civic Association

In this issue

Annual Membership Dues form...3
 Azalea Branch Library news...8
 Committees.....19
 Garage Sale.....14
 Home of the Month.....17
 Important Phone Numbers.....18
 January Meeting6
 JTCA Discussion List.....15
 JTCA Web Site.....15
 Monthly Meeting Minutes.....2
 Neighborhood Cleanup.....12
 Newsletter Articles.....18
 Officers and Board Members..19
 Science Center news.....9
 St Pete General Hosp.....13
 Tyrone Mall Renovation.....10
 Walter Fuller Center news....8

The next JTCA Meeting is scheduled for Monday, February 21st., Social 6:45PM, Meeting 7:00PM
 The meeting will be held at the newly remodeled Walter Fuller Youth Center, 7891 26th. Ave. N., St. Petersburg.



On the Agenda

- **KC Jones** - Realty Executives
- **Dean Miner** - Floridian, Pest & Turf Mgmt.



Newsletter Printed by



Mayor **Rick Baker**, **Lita Sargent**, Tyrone Square Mall Manager and **Tom Killian**, Jungle Terrace Civic Association President speak at the Tyrone Square Lifestyle Redevelopment Announcement on January 12, 2005. *Story on page 10.*

JTCA 2005 Elected Officers:

Linda Mouriski - Treasurer, **Bob Miller** - Board Member,
Lyn Dexter - Secretary, **Skip Mitchell** - Board Member, **Tom Killian** - President,
Ron Russell - Vice President, **Larry Dosh** - Board Member



Annual Membership Dues Due in January page 3



Mike Krautkremer's Lawn Maintenance

Residential/Commercial
Licensed and Insured
Landscape Services

Mow
Edge
Trim
Hedges
Mulch
Honest
Dependable



Free Estimates

Call (727) 647-0794

Your Neighborhood
Lawn Service

Minutes of the January 17, 2005 Monthly Membership Meeting

•The January 17, 2005 meeting opened promptly at 7:00 pm with 36 people signed in. After the Pledge of Allegiance, President **Tom Killian** introduced the 2004 Board Members. The Secretary's report was accepted as was the treasurer's report.



Lyn Dexter - Secretary

•Our CPO, **Rich Hladik** then reported there were only three auto thefts in the area, one of which the keys were inside. Officer Hladik advised there is a citywide problem with people leaving their keys inside their cars. The SPPD recently recovered a car with stolen items inside, but that was on the NE side. There were also two thefts in the area, one at Play It Again, and the other at a storage facility. When asked about the sexual predator list that had been supplied at every meeting, Officer Hladik stated the department was regrouping and should be able to supply such information at future meetings.

•The first speakers were **Karen and Tom Gargiulo** from the National Income Tax and Accounting. They have been in the business for quite some time and have an office at 2952 66th Street North. They are both certified and feel they supply private and personal service for their clients. They advised they can represent you in front of the IRS and can file taxes electronically. Further, they offer other services such as CPA, payroll, planning as well as many others. They welcome the neighbors to take advantage of their services with weekend and nightly appointments available.

•Our next speaker was **Karl Nurse**, President of C.O.N.A. (Council Of Neighborhood Associations). Mr. Nurse stated that he wants CONA to take a proactive approach to issues rather than a reactive stance. Further, in an attempt to help the neighbors in St. Petersburg, CONA is going to hold a meeting on Wednesday to discuss what issues they should be addressing set an agenda then work towards resolving these issues after the priority is set. This meeting will be held at the Sunshine Center, which is located at 330 5th Street North from 7:00 pm until around 8:30 pm with refreshments. The results of this meeting will be announced in the newsletter to inform the neighborhoods and to allow interested parties to participate. Monitoring such issues will aid at election time so as to determine if the politicians are really concerned with neighborhood issues.

•Mr. Nurse advised the common issues that come up include Codes and the Police Department. He did advise that due to CONA's input, the Codes Department has undergone some changes and should be working more efficiently in the near future. Other issues will most likely involve Crime, Recycling, Nuisance Noise, Underground Utilities, as well as Zoning and Development.

•The next order of business was the 2005 board elections. The election committee consisted of **Steve Plice, Ed Carlson** and **Mary Scott**. This committee nominated the following candidates for the board: President, **Tom Killian**, Vice President, **Ron Russell**, Secretary, **Lyn Dexter**, Treasure, **Linda Mouriski**, Board Members; **Skip Mitchell, Larry Dosh** and **Bob Miller**. After this announcement, the committee offered to take nominations from the floor, however there were none. It was then moved by **Ed Carlson**, seconded, then a unanimous vote

(Continued on page 7)

Grand opening!

Tiny Tykes



Consignment, Inc.

Wide selection of Children's clothing,
Maternity, School Uniforms,
Baby necessities and Toys.

Mention this ad and
receive a free gift!

6574 Central Ave.
(on the corner of 66th St. & Central)

727-343-4020

Art Stone
COMPANY INC.

Orchids



MICHAEL J. POLEN
PAULA J. POLEN
Seedlings to Blooming
All Potting Supplies

3611 Tyrone Blvd.
St. Petersburg
Florida 33710
(813) 345-6733



Rolls-Royce



JAGUAR

CHRYSLER





VOLVO



**Bill GRAMLEY'S
AUTOMOTIVE**
347-7676
JAGUAR - MERCEDES
BMW - VOLVO - ROLLS-ROYCE
EUROPEAN DOMESTIC JAPANESE

347-7676

JAGUAR - MERCEDES
BMW - VOLVO - ROLLS-ROYCE
EUROPEAN DOMESTIC JAPANESE

Extended Warranty

Service & Repair

Foreign & Domestic

SUV's



Pickup Trucks



3984 Tyrone Blvd. N., St. Petersburg, Fl. 33709

HONDA



Mercedes-Benz

GM



TOYOTA

"Warning! You want a warning? O.K., I'm warning you not to do that again or I'll give you another ticket."

2005 Annual Membership Dues Due in January

If you have not renewed your membership in the Jungle Terrace Civic Association, please take a moment to fill out this membership form and bring it to the next meeting or send your dues to the address below.

This is your neighborhood association and we work for you and your neighborhood. Please include \$12.00 per household annual membership dues, due in January of each year. If you can donate more than the membership dues it would be appreciated. We use the money to publish and mail your newsletter, hold a monthly membership meeting and sponsor an Easter Egg Hunt for the neighborhood children.

We are a Nonprofit 501 (c) 3 Tax Exempt Civic Association.

NAME: _____

ADDRESS: _____ ZIP _____

PHONE: _____

E-MAIL: _____

Dues: \$12.00 Donation amount: _____

Please make checks payable to:

Jungle Terrace Civic Association for \$12.00 .

Mail to: **Tom Killian, 2275 80th Street N. , St. Petersburg, FL. 33710** Phone 343-2041

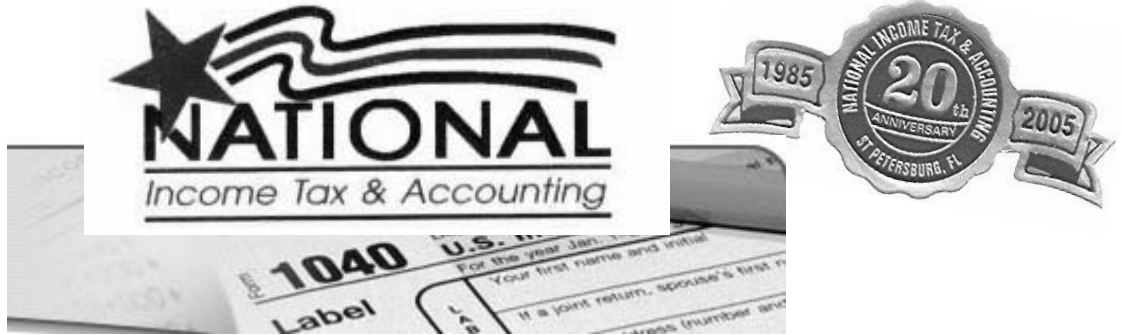

Your Neighborhood Tax Professionals



**Helping Individuals,
Businesses, Estates & Trusts
Since 1985**

When it comes to having your income taxes prepared and filed, choose National Income Tax & Accounting, Inc.

Our approach is simple: offer professional, personalized service at reasonable prices.

Professional

At National Income Tax your taxes will be prepared by a tax Professional. Tom & Karen Gargiulo are Enrolled to Practice before the I.R.S. For more information about E.A.'s, please go to our website www.nationalincometax.com.

Personalized

You will receive a personalized appointment in a private office. No waiting. No impersonal cubicles.

Reasonable

Our pricing is affordable and often less than our competitors. Call for a quote.

Tax Preparation

- Individuals
- Sole Proprietors
- Partnerships
- Corporations
- Estates
- Trusts



**\$ 10.00 Off
Tax Preparation**
new clients only

**Free E-Filing
\$ 40.00 Values**
with tax prep

**\$ 25.00 Off
Business Tax Prep**
new clients only

**Refund
Anticipation Loans**
from **\$ 89.00**

Conveniently located at
2952 66th St N

Call for an appointment
345-7790

www.nationalincometax.com



KC Jones
Broker-Vice President
 Realty Executives Cell: 727-458-5263
 4020 Park St. N Business: 727-347-1000
 St. Petersburg, FL. 33709 Fax: 727-345-6969



North East Charmer
 Masonary 3 bedroom 2 bath with wood floors, french doors, new kitchen with maple cabinets and corian counters. Stainless appliances, and tons of storage. Beautiful gardens with fountains and potting shed. 2 car garage with alley access.
\$325,000.00



Sold Properties in the Jungle since December 24, 2004

Address	bedrooms	Square	listed	Days on
	/ba	footage	Price	Market
2835 Park St N.	2/1	962	\$132,900.00	23
3120 66 Way N.	2/1	1000	\$140,000.00	54
8021 27 Ave N.	2/1	820	\$149,000.00	11
7940 24 Ave N.	3/2	1121	\$179,900.00	31
3550 70 Way N.	3/2	1416	\$209,900.00	7
8241 27 Ave N.	2/2	1208	\$239,000.00	58
2121 Park St N.	4/3	2094	\$330,000.00	19



Pinellas Park Starter home

2 bedroom 1 bath with newer breakfast bar kitchen, garage, and screen porch with large yard. **\$135,000.00**

The sold prices have not been included to protect the privacy of the Buyers. Please call for additional information. The information sited in this ad is obtained from the MLS system, Realtors, owners, and the public records. The properties have been listed and sold by various participants in the MLS System.



Tyrone Area

3 bedroom 2 bath with 1326 htd. sf. Immaculate condition with white cabinets and new appliances. New windows and Cent. H & A. Screen enclosed porch overlooks large corner oak shaded lot. ample room for boat or RV. **\$169,000.00**



Realty Executives your Local Real Estate Company



The Evolution of Diagnostics

For the past 35 years, St. Petersburg General Hospital has pursued the latest in medical advances to improve and save lives. Our DISCOVERY LIGHT SPEED PET/CT SCANNER enables us to deliver a higher standard of care than ever before to the people of our region.

The dual-image system empowers physicians to detect, diagnose and treat cancer faster and more precisely for better outcomes. And that is good news for everybody. Ask your physician, or call us with questions about this new technology, now at St. Petersburg General Hospital. Our brochure will clearly explain the



benefits of this one-step PET/CT diagnostic system over its ancestors.
 >Fuses the finest of PET and CT scan technology

- >Diagnostic tests that previously took weeks can now take an hour or less
- >High-resolution images are electronically transferred to specialists for fast review and expert opinion
- >Elimination of multiple tests saves time and anxiety
- >Images mesh perfectly since patient remains in one position
- >Faster diagnosis and more precise treatment for better outcomes

ONE APPOINTMENT.
ONE TEST.
ONE PLACE.
CALL 341-4077.



January 2005 Meeting



Karen and Tom Gargiulo of National Income Tax & Accounting (*above*) spoke about income tax preparation, accounting for small businesses, Financial Services, and new tax laws at our January Meeting. Karen and Tom are supporters of the Jungle Terrace Civic Association. See their ad on page 4.

Karl Nurse, President of CONA (Council of Neighborhood

Associations) (*below*) also spoke at the meeting. Karl discussed CONA's vision for the future, successes, and disappointments.

Both presentations were very informative.

Elections were held for association officers. Picture and names are on the front page.



(Continued from page 2)
elected the nominees.

•**Tom Killian** then advised of the status of various ongoing projects. He advised of a meeting with **Lee Metzger** with Leisure Services regarding the skateboard park. A flyer was passed around showing the design of the park, which differed from the first park built at Fossil Park. Further, the hold up of construction is the moving of the BMX facility, which will begin after a big event scheduled for May. If the BMX is moved out by the end of May, the new park should be ready by the end of the year.

•**Tom Killian** then announced the scheduled events for 2005 including:

•February 14th and 28th Neighborhood cleanup, check the newsletter for a map of the neighborhood and the dates of the pick up.

•February 26th Neighborhood Garage Sale, contact **Brad Rice** for a table. This will take place outside the Walter Fuller Center in conjunction with the youth center. \$10 per table for non-members and \$5 for JTCA Members. SPPD representative to give away THE CLUB to the owners of certain types of vehicles.

•March 26th Easter Egg Hunt, this year the Azalea Neighborhood will be co-sponsoring this event. The Easter Bunny will be available for photos with the kids.

•April 18th Monthly meeting will be held at Sunken Gardens. **Mary Campbell** will be speaking after which we will be allowed to walk through the gardens. Any one requiring special assistance with transportation should contact a board member.

•April 23 and 24th Green Thumb Festival, JTCA will have a booth for which we will need volunteers to man.

•October 8th Pets in the Park, this year we will add a Blessing of the Animals by **Mary Beth Packard**.

•November 5th Neighborhood Picnic, this year will be held in conjunction with CONA and will be held at the Water Fuller. There will be food and Blue Grass Music.

•**Tom Killian** then took a minute to thank all those who volunteered their help with the events last year and commented that additional volunteers are needed for the upcoming events. He also advised of the monuments that are to be placed in the industrial park, which will be funded through a Grant from the City.

•**Ron Russell** then advised that if there were enough people interested, we could organize a trip to the Crime Lab facility. Please call a board member if interested.

•There were several questions from the attendees of the January meeting regarding the legality of scooters. Scooters (non-motorized) need to be registered and can only be on a private land. If ticketed, the fee is \$80 and the owner has to walk the scooter home if he/she gets a ticket. If motorized, a scooter must be licensed and must operate on the street, not on the sidewalk. However it is only required to have insurance if driver is not wearing a helmet.

•The meeting was adjourned at 8:31 pm



Never be afraid to try something new. Remember that a lone amateur built the Ark. A large group of professionals built the Titanic.



MAIL BOX EXPRESS

3993 Tyrone Blvd., #608
At Walmart Plaza



St. Petersburg, FL. 33709

Mon - Fri, 9 a.m. - 5:30 p.m.

Sat 9 a.m. - 4 p.m.

Phone (727) 384-2811

Fax (727) 384-2712

*For all your packaging
Office & Small Business Needs.*

15% Off **Coupon**
Your first U.P.S. Shipment GROUND

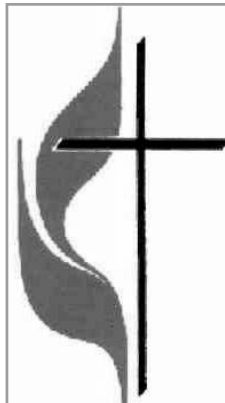

Christ United Methodist Church
467 First Avenue North
St. Petersburg, FL 33701
727-833-3343

E-mail: cumcsp@cumcsp.org
Website: cumc.happychurches.com
Traditional Worship: 8:30 am
Contemporary Worship: 9:00 am
Celebrative Worship: 10:45 am

Pastor: Rev. Tom Norton, Jr.



Science Center
Of Pinellas County, Inc.

7701 22nd Avenue North, St. Petersburg 33710

Phone: (727) 384-0027

www.sciencecenterofpinellas.com

Monday-Friday 9 a.m.-4 p.m., Saturday 10 a.m.-4 p.m.

Saturdays \$5/Person, Special Shows & Exhibits
for the whole family!

Classes & Workshops for Pre-K through 12th Grade!



Azalea Branch Library News

Teen Programs

Teen Scene

Every Thursday 6:30pm - 8pm

Adult Programs

Book Discussions

Always call for time and date (727-893-7930)

Children's Programs

Mother Goose : (infants - 3 years)

Tuesdays and Wednesdays 11:00am

Preschool Story Time: (ages 3-5)

Tuesdays and Wednesdays 10:00am

"Family Storytelling Night"

1st Thursday of every month at 7:00. We tell stories for all ages and do a related craft.

Azalea Branch

7801 22nd Ave N

St Petersburg, FL. 33710

Mon, Wed, Fri, Sat 9am - 6pm

Tue, Thur 9am - 9pm

727-893-7930



by Donarita Vocca

"Junk is something you've kept for years and throw away three weeks before you need it." - Unknown

Walter Fuller Center News

(727) 893 - 7443

Garage Sale

The Jungle Terrace Civic Association and Walter Fuller Recreation Center are having a garage sale on February 26th from 8:00am to 12:00pm. If you are interested in selling items at the garage sale, tables can be rented for \$10 (if you are a Jungle Terrace member the cost is \$5). Tables are limited so please sign up early. The deadline for renting a table is Thursday, February 24th.



Spring Playcamp

Walter Fuller Recreation Center will have a Spring Playcamp the week of March 21-25. The full day camp costs \$55.00 and runs from 7:30 am to 5:30 pm. Parents need to pack a non-refrigerated lunch each day. If you are interested in signing up your child, please stop by the office to fill out an application.

The After School Program

Our After School Program currently has spots available for children in kindergarten thru 5th grade. The program hours are from school dismissal time until 5:30pm. An extended care program runs until 6:00 pm for \$25.00 per month. The monthly cost for camp is \$99.00 and is due by the 8th day of each month. If you are interested in signing up your child please stop by the office to fill out an application.



by Brad Rice

Grandma's Apron

The principle use of Grandma's apron was to protect the dress underneath, but along with that, it served as a holder for removing hot pans from the oven; it was wonderful for drying children's tears, and on occasion was even used for cleaning out dirty ears.

From the chicken-coop the apron was used for carrying eggs, fussy chicks, and sometimes half-hatched eggs to be finished in the warming oven.

When company came those old aprons were ideal hiding places for shy kids; and when the weather was cold, grandma wrapped it around her arms.

Those big old aprons wiped many a perspiring brow, bent over the hot wood stove. Chips and kindling-wood were brought into the kitchen in that apron.

From the garden it carried all sorts of vegetables. After the peas had been shelled it carried out the hulls.

In the fall it was used to bring in apples that had fallen from the trees.

When unexpected company drove up the road, it was surprising how much furniture that old apron could dust in a matter of seconds.

When dinner was ready, Grandma walked out on the porch and waved her apron, and the men knew it was time to come in from the fields for dinner.

It will be a long time before anyone invents something that will replace that old-time apron that served so many purposes.

-- author unknown --



The Plumber that offers you a choice!

Call us today and

EXPERIENCE THE DIFFERENCE

Water heaters - Water Conditioners

Water filters - Remodeling

Six months same as cash

(727) 526-7600

www.stpeteplumbing.com

"We Work Miracles!"

CFC051641

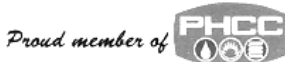

Mark Pelham

Store Director

ALBERTSONS INC. 3900 66TH. STREET NORTH
SAINT PETERSBURG, FLORIDA 33709

727-381-4312 FAX 727-381-6324



The Science Center

SUPER SATURDAY, FEB. 5 - THE SCIENCE OF SPORTS
with the Tampa Bay Devil Rays! Learn sports safety,
kids throw balls with Rays Players, Autograph Sign-
ing and More!



See the web site:
sciencecenterofpinellas.com
for more information!



The Science Center is a unique learning environment for children through adults that offers hands-on educational activities to promote the understanding of science. Over 70,000 visitors of all ages take part each year in special programs, lectures, exhibits and events!

What have you been missing?

- Spirit of Columbia Theater & Planetarium.
- 600-Gallon Marine Touch Tank .
- 16th Century Indian Village.
- Live Animal Room.
- Fun Laser Shows
- African American Inventions Exhibit.
- Fall, Spring & Summer Workshops .
- Customized Birthday Parties
- Presentations for Girl & Boy Scouts.
- Monthly Evening Events for Families .
- Fun Festivals



The Science Center is open:

Monday-Friday 9 a.m.-4 p.m.

Admission: \$1 / Person, for self-tour.

Saturday 10 a.m.-4 p.m.

Admission: \$5 / Person includes all shows, exhibits & special programs.

The gift shop is open during the hours above. Also, Gift Certificates for Super Saturdays and Memberships are available.

Please look in the paper and check our Web Site

sciencecenterofpinellas.com

by Marie Stempinski

When the driver of a huge trailer lost control of his rig, he plowed into an empty toll-booth and smashed it to pieces. He climbed down from the wreckage and within a matter of minutes, a truck pulled up and discharged a crew of workers.

The men picked up each broken piece of the former toll-booth and spread some kind of creamy substance on it. Then they began fitting the pieces together. In less than half an hour, they had the entire tollbooth reconstructed and looking good as new.

"Astonishing!" the truck driver said to the crew chief. "What was the white stuff you used to get all the pieces together?"

The crew chief said .. "Oh, that was tollgate booth paste."



Don Can Fix It!

Yes he can!

Home Maintenance and Repairs

From Furniture Assembly to Hauling; from Pressure Washing to Yard Work - Let us whittle down your "Honey Do" List

Need it fixed? Give us a call!

Phone: 727-688-3946

Email: info@doncanfixit.com

On the web at: www.doncanfixit.com

**Don Rogers
a Jungle Terrace Resident**



Serenity Pools, Inc

Specializing in Quality Remodels
and New Construction



**Kim Bingham
(727) 224-9961**



Office: (727) 345-8996
Fax: (727) 343-2295

Rick & Kim Bingham
Owners/Operators
State Lic. #CPC1456564



Life, Annuities,
LTC, Health
Return on Premium Life

**John G. Conklin
Consultant**

Laake Financial Services, Inc.

1070 Kapp Drive • Clearwater, FL 33765

Phone: 727-443-4571 ext. 213
Fax: 727-447-2405
E-Mail: johnglenn36@hotmail.com

Serving All
Insurance
Needs



Facade view of new proposed Lifestyle renovation.

TYRONE SQUARE ANNOUNCES NEW LIFESTYLE COMPONENT

Exterior Renovation Also Planned As Part Of Redevelopment -

ST. PETERSBURG, FL (January 12, 2005) – Simon Property Group, Inc. (NYSE:SPG), owner and manager of Tyrone Square, revealed its plans today for a multi-million dollar redevelopment project which will add a lifestyle component to the area between Sears and Burdines-Macy's. The project includes the addition of new stores and restaurants, as well as an exterior renovation that will create a brand new look and enhance the overall ambience of the shopping center.

Merchant relocations and demolition work has begun with major construction work to begin in February. New merchants will start reopening during the summer and throughout the fall, with the entire project scheduled to be completed for the 2005 Holiday Season.

"This project will give Tyrone Square, which will be 33 years old this year, a fresh new look and feel," said Jeni Wadlow, Director of Mall Marketing. "By bringing the best of both worlds together, the enclosed shopping center and the lifestyle center, Tyrone Square and Simon Property Group continue to deliver on our commitment to improve the quality of the shopping experience for our shoppers and community," Ms. Wad-

low added. She also noted that Tyrone Square would remain open for business during each phase of the redevelopment with no interruption to shoppers.

Shoppers can look forward to the addition of several new stores and quality restaurants to Tyrone Square and the St. Petersburg market. The new lifestyle area will include an extensive renovation to the exterior of the building to create a streetscape appearance, as well as an additional mall entrance. New exterior parking lot lighting, landscape islands, patio restaurant seating, up front parking spaces and a pedestrian walkway from Tyrone Boulevard are further enhancements which will update the center's appearance.

Tyrone Square, located at Tyrone Boulevard at 66th Street North and 22nd Avenue North is a super-regional center serving a substantial portion of the Tampa - St. Petersburg - Clearwater metro area. Tyrone Square opened in 1972, and is currently anchored by Burdines-Macy's, Dillard's, JCPenney and Sears and features more than 170 specialty retailers and eateries. Tyrone Square underwent a mallwide renovation in 1998. An eight-unit food court, Borders Books & Music and Tia's Tex-Mex Restaurant were added between 1998 – 2000.

Simon Property Group, Inc., headquartered in Indianapolis, Indiana, is a real estate investment trust engaged in the

SIMON

PROPERTY GROUP

SAFFRON'S
AT HISTORIC JUNGLE PRADA *Caribbean Cuisine*

- FINE DINING
- OUTDOOR DINING
- EXPRESS CATERING
- BANQUET FACILITIES
- TAKE OUT

1700 PARK STREET N.
ST. PETERSBURG, FL 33710
727-345-6400

MON-THURS 11AM-9:30PM
FRI & SAT 11AM-10PM
SUN 2PM-10PM • BRUNCH 11AM-2PM

There is always something happening at Saffron's!

WWW.SAFFRONSCUISINE.COM

Sponsors Needed!

If you live in the Jungle Terrace neighborhood and own a local business, we need your help to sponsor your neighborhood newsletter, the official monthly publication of the Jungle Terrace Civic Association. Our rates are reasonable and our newsletter reaches people in your area that can purchase your service.

Business Card Size ad \$45.00 a year
 ¼ Page Ad \$115.00 a year
 ½ Page Ad \$225.00 a year
 Full Page Ad \$450.00 a year

You supply full page (8.5 x 11) insert
\$30.00 for one month

Please call Tom Killian, 343-2041, and I will be glad to tell you how our newsletter can help you increase your business.



**Heather Pillion
Janice Kaplan
Owners**



Bath & Biscuit
Pet Boutique, LLC.

- Grooming
- Barkery
- Natural Pet Products & Supplies

tel: 727.345.8118
6840 22nd Ave. N. St. Petersburg, FL 33710
e-mail: bathnbiscuits.com@verizon.net

Vet Recommended



Apple
Dental Group

Dr. Phillip Apple
Dr. Richard Edwards
Periodontist
Dr. Terryl Crawford
Endodontist

6759 First Avenue South
St. Petersburg, FL. 33707

727-381-1642 Fax 727-384-0764

Apple Dental Affiliates, PA

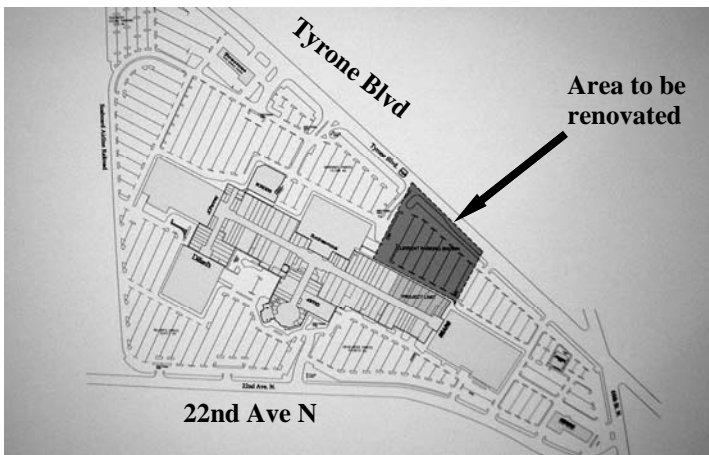

ownership, development and management of retail real estate, primarily regional malls, Premium Outlet® centers and community shopping centers. The Company's current total market capitalization is approximately \$36 billion. Through its subsidiary partnerships, it currently owns or has an interest in 299 properties in North America containing an aggregate of 203 million square feet of gross leasable area in 39 states plus Puerto Rico, Canada and Mexico. Simon also holds interests in 49 European shopping centers in France, Italy, Poland and Portugal and 4 Premium Outlet centers in Japan. Additional Simon Property Group information is available at <http://www.simon.com>.

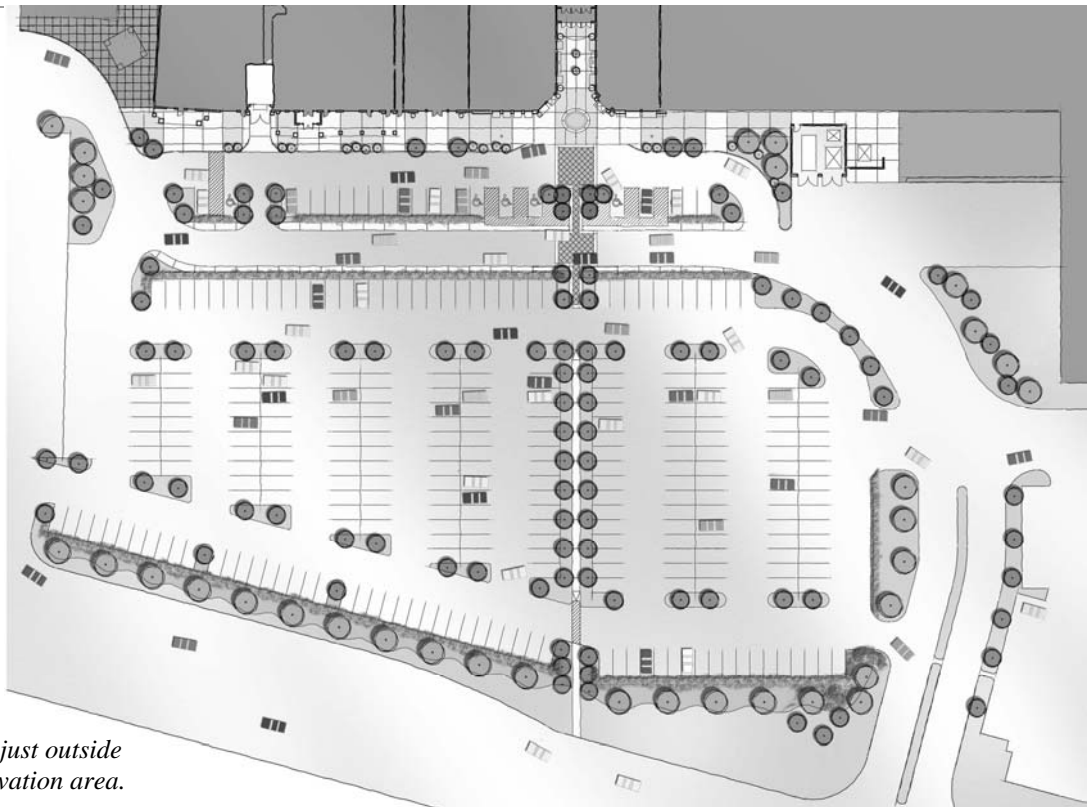

Overhead view of parking area just outside the new proposed Lifestyle renovation area.



“Neighborhood Cleanup Days”



February 14th and **February 28th** are designated Neighborhood Cleanup Days in the Jungle Terrace Neighborhood. The City will provide trucks to pick up those hard to discard items like old furniture, appliances, carpeting, yard waste, limbs (up to 4 feet long), and junk from the garage. This is a free pickup.

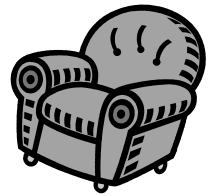

The cleanup will proceed as follows. For those residents on the East side of Tyrone Blvd, you must put your cleanup items **at your curb on February 14th at 7:00 am.** The city will provide trucks to pick up your items. If all the items can't be picked up on February 14th, pickup will continue on the day/s that follow until completed but the items must be put **at the curb on February 14th at 7:00 am.**

For those residents that live West of Tyrone Blvd, this process will start on **February 28th at 7:00 am.**

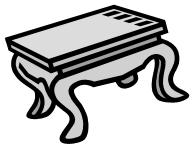

The City's Sanitation Department **WILL NOT** pick up hazardous wastes (paint, solvents, pesticides, etc), junk cars or building materials.

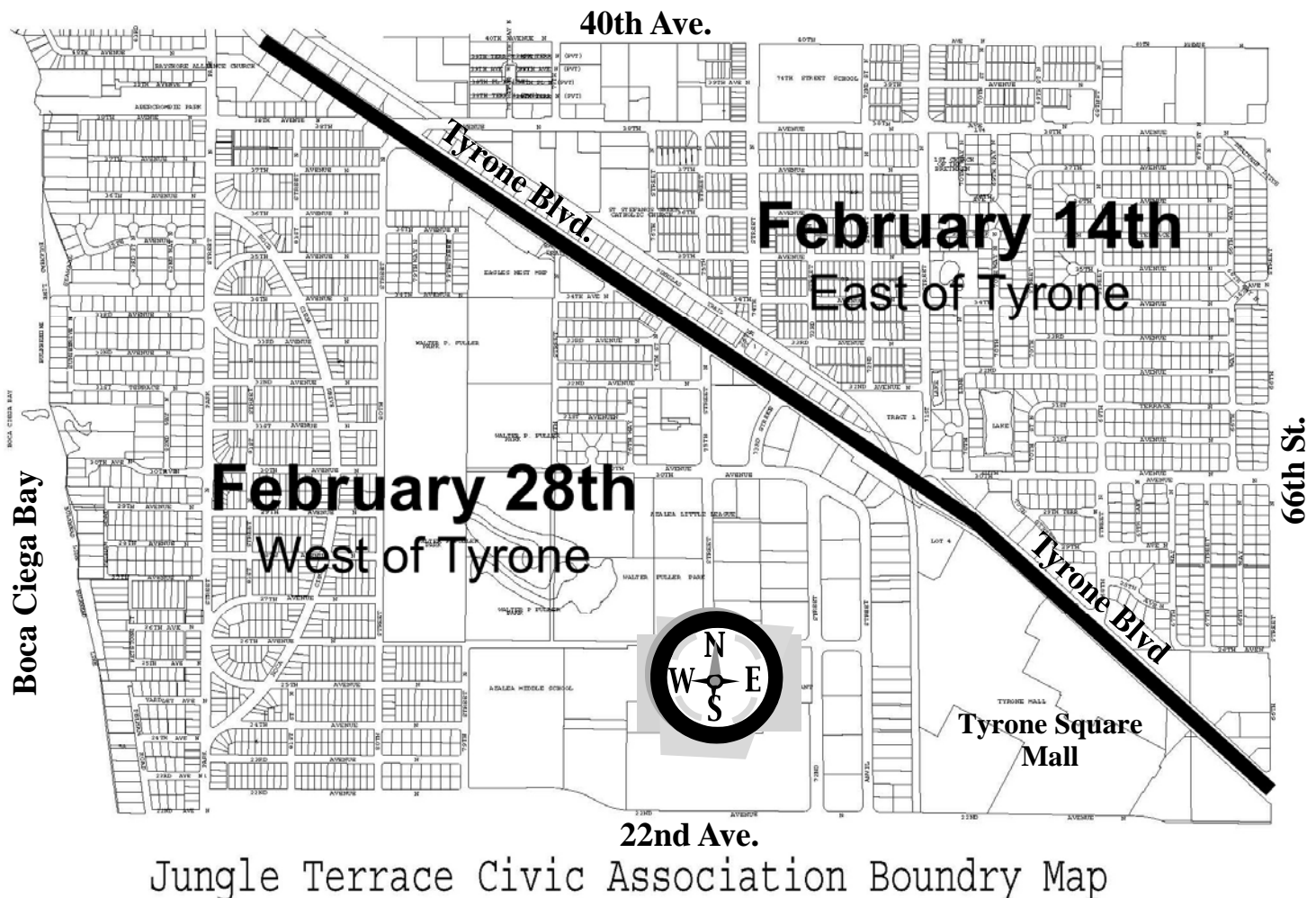

Johnny Leverock's St. Pete Beach

We would like to thank the local community for 20 years of support at this location.

We are still serving all of the great recipes that the Leverock Family taught us in 1980.

We have stuck with the basic principles that Johnny Leverock had in 1948.

- Fresh Local Fish • Famous Clam Chowder •
 - Delicious homemade Pies •
- like our Peanut Butter or Key Lime Pies all made right in our kitchen.*



Sincerely,
George Lewis, John Stross & Vanessa Parnell
 Owners Since 1984

P.S. ~ Don't forget our Sweeping Water Views!

🐟 10 Corey Avenue, St. Pete Beach 🐟 727-367-4588 🐟

St Petersburg General Hospital

We are proud to have the St Petersburg General Hospital as a new sponsor of the Jungle Terrace Civic Association.

St. Petersburg General Hospital is a 219-bed acute care hospital offering a full spectrum of health care services with the support of over 750 employees and volunteers, and 500 independent physicians.

Life at St. Petersburg General is about starting out, growing up, and growing better. It's about helping our community enjoy every stage of it in good health.

The range and scope of services is driven by community needs; by how new discoveries in breakthrough technology can improve outcomes.

The ER has tripled in size and scope. Exceptional physicians and surgeons, advanced diagnostics and treatments along with innovative services greatly enhance quality of care. Education programs are focused on prevention and wellness and their mission is supported by a staff with an unwavering passion for excellence.

SERVICES AND CENTERS OF CARE INCLUDE:

- 24-Hour Emergency Care
- Day Surgery
- Advanced Diagnostics, newly installed PET/CT

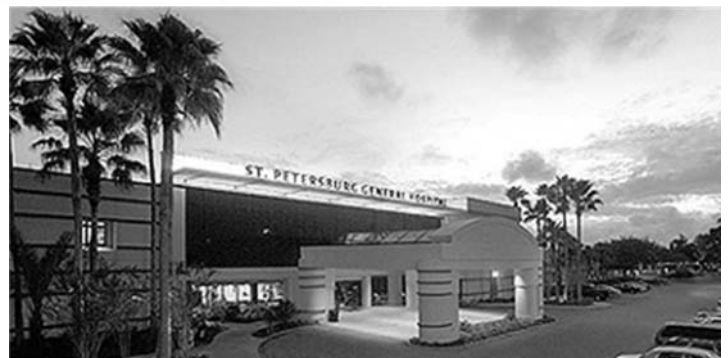

- Vascular Services
- Spine Care Program
- Outpatient Rehab
- Obstetrics
- Level 1 Neonatal
- Women's Health Services
- Wound Care Center
- Occupational Medicine

6500 38th Avenue north, St. Petersburg, Fl. 33710

For information about their exceptional menu of healthcare services, and educational programs, contact them at: (727) 384-1414 or Visit us at www.stpetegeneral.com



Garage Sale

Saturday February 26th. 8AM-12PM

Walter Fuller Youth Center (outside)

7891 26th. Avenue N. St. Petersburg.

CO-Sponsored by

**The Jungle Terrace Civic Association
and the Walter Fuller Youth Council.**

Table Rental - \$10.00 (Jungle Terrace members - \$5.00)



The table rental fee goes to the Youth Council to support their activities. All sales go to the person who is renting the table. If you would like to donate any part of your table sales to Jungle Terrace it would be appreciated.

Please clean out you garage and home of items that are saleable and make money for yourself.

Don't wait until the last minute to rent your table, call **Brad Rice** at the **Walter Fuller Youth Center** 893-7443.

Get a Car Club For Free

If your car qualifies as a targeted stolen vehicle the City of St. Petersburg will give you a car club free. **John Harris** Crime Watch Coordinator will be at our Garage Sale on Saturday February 26th. 8AM to 12PM, Walter Fuller Center. Free Clubs will be given out to the below list of vehicles. Please bring your automobile registration and drivers licence.

- **Dodge/Chrysler products: Any Year**
- **Saturn 1991-1997**
- **Nissan Altima 1991-1997**
- **Toyota Camry 1988-1994**
- **Honda Accord 1995-1998**
- **General Motors 1980-1998**

Clubs have been proven to be effective in keeping your car from being stolen. Please take advantage of this good opportunity to get one for free.

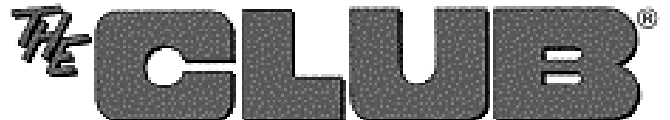

Mountain Memories

Traditional Bluegrass Music



Pete Lissman Guitar (727) 536-8508

Bob Miller Banjo (727) 343-4436

E-mail—Bluegrassbob@earthlink.net

Bluegrass music for all occasions

KR FRITZ

- **Designs & Drafting**
 - **Residential Addition & Renovation Construction Plans**
 - **Ready to Permit & Build**
 - **Ideal for Homeowner Contractor or Outside Contractor**
 - **Construction Consulting**
- ## 384-4331

Mention this ad for a \$50 Discount

What was the best thing before sliced bread?

February 2005

Astrological Sign: Aquarius (January 20 - February 18) and Pisces (February 18 - March 20)

Flower of the Month: Violets

Birthstone: Amethyst

	Last Quarter	2nd	2:27 a.m.	2nd	Groundhog Day
	New Moon	8th	5:28 p.m.	9th	Ash Wednesday
	First Quarter	15th	7:16 p.m.	14th	Valentine's Day
	Full Moon	23rd	11:54 p.m.	21st	Presidents Day

March 2005

Astrological Sign: Pisces (February 18 - March 20) and Aries (March 20 - April 20)

Flower of the Month: Jonquil

Birthstone: Aqua Marine

	Last Quarter	3rd	12:36 p.m.	17th	St. Patrick's Day
	New Moon	10th	4:10 a.m.	20th	Spring Begins
	First Quarter	17th	2:19 p.m.	27th	Easter Sunday
	Full Moon	25th	3:58 p.m.		

Jungle Terrace Web Site

We have a web site for the Jungle Terrace Civic Association. It is at URL www.JungleTerrace.org. It is available for viewing to anyone that has internet access. The web site has important organizational information, a Neighborhood map, the soft-copy Newsletter and much more. The Newsletter and map are in PDF format. If you don't have the Adobe PDF reader you can download it free at www.adobe.com Look for this button



Questions contact Webmaster Bob Miller at BluegrassBob@earthlink.net

The Jungle Terrace Internet Discussion List

Jungle Terrace has an Internet discussion list that is available to all neighborhood residents free. If you have a computer you can join. Learn what is happening today. Don't wait until the next meeting or until you receive your next newsletter. When you sign onto the list, you can then participate in discussions concerning things that are important to our neighborhood. Help us solve problems and make our neighborhood the best in the city. To join the list, send an e-mail to Steve Plice at steveplice@verizon.net



RAHEB Family Chiropractic



Dr. Jeffrey Raheb

Chiropractor

Wellness • Injury • Accident

6701 - 38th Avenue N., Suite B-1
St. Petersburg, FL 33710

Office: (727) 381-3456 • Cell: (727) 692-0643 • Fax: (727) 381-3762

Se Habla Español
Children • Medicare

DAN'S HAULING, INC.

Mary Lombardi / Treasurer
8110 30th Ave. N., St. Pete, FL 33710
(727) 341-1135 • Fax (727) 381-1114



WE HAUL ANYTHING!

- Construction Sites
- Demo Work
- Garage Clean-Outs
- Yard Clean-Ups
- Drop Off Service
- 12 Cu Yard
- Same Day Svc.
- Free Estimates



Greetings,

Did you know one of the most stressful aspects of modern life is dealing with the problems that arise after an automobile accident?

Were you also aware that some automobile accident injuries are often not detected for months or even longer?

As a result, a lot of accident victims settle their case with the insurance companies before being evaluated by a doctor trained in automobile accident injuries.

This could be a big mistake.

Why? Because once you settle your case you lose the right for compensated care if you need it.

A good rule of thumb is to determine your rights, and then to make a decision. There is no reason to rush; it can only hurt you.

It is our position that if you have indeed been injured in an automobile accident, you should get all the care necessary to get back to the way you felt and functioned just before the accident.

Bear in mind that it is not the responsibility of the insurance company to pay for anything more than a return to normal functionality. They are not responsible for pre-existing injuries, but only the injuries resulting from the accident.

Even if you experience only mild soreness, you should be evaluated immediately. It's possible you could experience problems directly caused by the accident - pain, numbness, headaches, muscle stiffness, fatigue, even arthritis - many months later.



Remember, **NOTHING** is more important than your health when you start to lose it.

Discovery Learning Center At PARC

Caring for and educating children of all abilities since 1953



M-F 7am-6pm
Lic. #C680083
We accept CCC

Credentialed Teachers / Experienced staff
Nurse on staff
Small Classes
Toddler Computer Lab
Toilet Training / Independent self-care skills
Trained to work with special needs
On-site therapy (PT, OT, Speech, Behavior)

Day Care / Early Intervention / Before & After School / Pre-K / Summer Camp

3100 75th St. N. 727-345-9111

www.discoverylearning.org

(727) 344-1604

Extra Closet

100% Air Conditioned Storage

KEN & BOB
Managers

2401 Anvil Street N.
St. Petersburg, FL 33710

Your Ad Could Be Here.

Business Card Size	\$45.00 a year
¼ Page Ad	\$115.00 a year
½ Page Ad	\$225.00 a year
Full Page Ad	\$450.00 a year
You supply full page (8.5 x 11) insert.....	\$30.00 for one month

Call Tom Killian 343-2041 or
Bob Miller 343-4436



Sponsors Needed!

If you live in the Jungle Terrace neighborhood and own a local business, we need your help to sponsor your neighborhood newsletter, the official monthly publication of the Jungle Terrace Civic Association.

Our rates are reasonable and our newsletter reaches people in your area that can purchase your service.

Business Card Size ad	\$45.00 a year
¼ Page Ad	\$115.00 a year
½ Page Ad	\$225.00 a year
Full Page Ad	\$450.00 a year
You supply full page (8.5 x 11) insert	
.....	\$30.00 for one month

Please call Tom Killian, 343-2041, and I will be glad to tell you how our newsletter can help you increase your business.

FASTSIGNS®

Sign and Graphic Solutions

Made Simple.®

- Banners
- Vehicle Graphics
- Full Color Graphics
- Exhibits & Displays
- Safety & ID Signs

www.fastsigns.com



4058 Park Street - St. Petersburg

727-341-0084



February Home of the Month by Mary Scott

Neighborhood Pride doesn't go any deeper this month when talking with **Debby Dailey**. Beaming as she recounts the changes she & **Ken** have recently completed on their home of 18 years. They have truly brightened the face of the neighborhood that they love so much. Interior renovations adorn but it's the exterior that really catches one's eye as you drive by 2901 Park Street North. The bold new house color is complimented by lush landscape that includes green palms & colorful perennials. You're an inspiration to us all.

Congratulations and thank you Debby & Ken!

If you have, or know of a property that you would like to have nominated as Home of the Month, please call 384-1718.

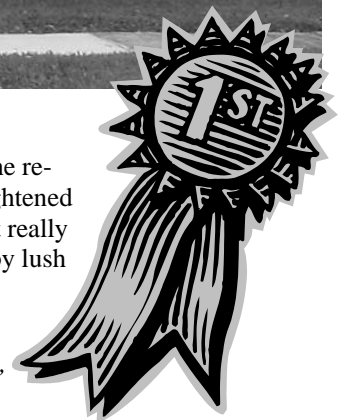

Mediation Specialists
 Providing Dispute Resolution For the
 Commercial, Business & Residential
 Community.

We Specialize in Pre-Litigation Conflicts
 Regarding Consumer, Employee, Contract and
 Insurance Disputes. We offer Flexible
 Scheduling

Telephone: 727/345-7000
 Cert# 01933R Not a Law Firm

Stylecraft

Window Treatments, Inc.

501 - 9th STREET NORTH
 ST. PETERSBURG, FLORIDA 33701-2198
 PHONE 894-6858 • FAX 821-5566
 TOLL FREE 1-800-758-2759

Armand Theodore Joyal II
 Manager

- DRAPERIES & BEDSPREADS
- VALANCES & TOP TREATMENTS
- VERTICAL & HORIZONTAL BLINDS
- MICRO & MINI & MID SIZE BLINDS
- SHUTTERS & 1" & 2" WOOD BLINDS
- DUETTE & CELLULAR SHADES
- FABRIC PLEATED SHADES
- UPHOLSTERY & WALLPAPER
- CARPET & FLOORING
- REPAIRS & ALTERATIONS

CFI MORTGAGE

a Division of CFIC Home Mortgage, Inc.
 Correspondent Lender

Your Neighborhood Mortgage Company
 Purchase, Refinance, Debt Consolidation

- Free pre-approvals
- No Discount Points
- No Application Fee
- Low, Low Rates
- FHA /VA /Conventional
- Programs for Credit Challenged Borrowers

The One Call Worth Making...

100% Call Rick Bull
 Financing Available **727-344-0683**



Newsletter Articles

Do you have a letter, issue, article, or recipe you would like to publish in the JTCA newsletter? We welcome letters, comments, and contributions from our neighbors.

We would like to invite you to create articles that will inform our neighbors about items of interest relating to our neighborhood. Some suggested subjects are Pinellas Trail, Tyrone Corridor, Tyrone Square Mall, the Dog Park, Pool and Tennis Courts, Soccer League, Azalea Little League, Walter Fuller Park, the Devil Rays Complex, History of Abacrombie Park, our Linear Park 30th. Ave. N., the two schools in our area, Walter Fuller Center after renovations, Mobile home park on 34th. Ave, recipes, etc.

Photos are welcome. We can also take photos for your article. Articles and photos can be in soft-copy (preferred) or hard copy.

Send to; Bob Miller 8215 30th Ave N 343-4436

BluegrassBob@Earthlink.net

Article and Advertising Acceptance Policy

Articles will not be accepted which in any way is considered to be lacking in judicious good taste or moral propriety, or which demeans any particular race, language, religion, or political view. Articles of a controversial political nature will not be accepted. Advertising of a controversial political nature will not be accepted. Advertising found to contravene truth, exaggerate the description of a product or service, or containing fraudulent statements will not be accepted. Advertising is accepted with the conditional understanding that the sponsoring company and principal beneficiary of the advertisement is ultimately responsible and liable for its content. We reserve the right to reject or revise all copy submitted, or to cancel advertising at any time.

Important Phone Numbers

Emergencies	911
Rich Hladik, Community Policing Officer	892-5952
Police (non-emergency)	893-7780
(CASA)	898-3671
City Council Office	893-7177
Codes (get a case number)	893-7373
Elderly Information	893-7101
Garbage Collection Inf.	893-7334
Graffiti	893-7394
Library (Azalea)	893-7930
Mayor's Action Center	893-7111
Mosquito Control	464-7503
PARC (Pinellas Assoc. for Retarded Children)	345-9111
Public Service Rep. (Susan Fuchs)	893-4137
Rodent Control	893-7360
Schools; 74th St. Elementary	893-2120
Azalea Elementary	893-2187
Azalea Middle	893-2606
Street Light Maintenance (CL & P)	1-800-228-8485
Tip Line	892-5000
Water & Sewer Problems	893-7761
Walter Fuller Center	893-7443
Walter Fuller Pool	893-7636
For a free smoke detector	
Or home inspection	893-7233





TAXI

(727) 367-3702

www.BatsTaxi.com

Fax 367-8354

P.O. Box 66330 • St. Pete Beach, FL 33736

EAGLES NEST RESIDENTS, INC.

7801 34TH Ave North
 St Petersburg FL 33710

Phone & Fax (727) 347-7909
 Resident owned Mobile Home Community
 Age 55 and over RV'S WELCOME
 rental and sales of mobiles

**Mark Your Calendar
 2005 Meeting Dates**

January 17	February 21	March 21
April 18	May 16	June 20
July 18	August 15	September 19
October 17	November 21	December No Meeting

Social 6:45 P.M. Meeting 7:00 P.M.

Kids

While walking along the sidewalk in front of his church, our minister heard the intoning of a prayer that nearly made his collar wilt.

Apparently, his 5-year-old son and his playmates had found a dead robin. Feeling that proper burial should be performed, they had secured a small box and cotton batting, then dug a hole and made ready for the disposal of the deceased. The minister's son was chosen to say the appropriate prayer and with sonorous dignity intoned his version of what he thought his Father always said: "Glory be unto the Faaaather, and unto the Sonnn.. and into the hole he gooooes."



**For A Lush Green
 Beautiful Lawn
 and
 Pest Free Home**

Certified Pest Control Operator
 & Horticulturist on Staff



"Call Us
 & Relax"



FLORIDIAN
 PEST & TURF MANAGEMENT, INC.

- Lawn Spraying
- Fertilizing
- Weed Control
- Pest Control

RESIDENTIAL & COMMERCIAL
 Professional Lawn Care & Pest Control

(727) 344-2407

Officers and Board Members

President	Tom Killian	343-2041
Vice President	Ron Russell	345-7000
Secretary	Lyn Dexter	345-7000
Treasurer	Linda Mouriski	381-4845
Board Member	Mary Lou Mitchell	345-4408
Board Member	Bob Miller	343-4436
Board Member	Larry Dosh	343-3070

Committees

	{ BluegrassBob@Earthlink.net }	
Newsletter Editor.....	{ Bob Miller	343-4436 }
Newsletter	Tom Killian	343-2041
Membership	Linda Mouriski	381-4845
Traffic	Ron Russell	345-7000
Home of the month	Mary Scott	384-1718
CONA Report	Steve Plice	344-3120
Welcoming	Tom Killian	343-2041
	{ BluegrassBob@Earthlink.net }	
WebMaster.....	{ Bob Miller	343-4436 }
Meeting Refreshments.....	Tom Killian	343-2041



Jungle Terrace Civic Association
Member: Council of Neighborhood Assoc.
2275 80th Street North
St. Petersburg, Florida 33710
E-Mail: tomkillian@juno.com

Forwarding Service Requested

PRSR STD
U.S. POSTAGE PAID
St. Petersburg, FL
Permit No. 1084



COPYRIGHT NOTICE.

Clipart used in articles in this publication is from MS Publisher 2003 and the MS Office Online, Clipart and Media Site.
Copyright © 2003 Microsoft Corporation, One Microsoft Way, Redmond, Washington 98052-6399 U.S.A. All rights reserved.