

Circulation 600

Boca Ciega Bay



Jungle Terrace Civic Association

In this issue

2004 Year in Review.....20
 Azalea Branch Library news...8
 Committees.....19
 Floridian Plant Care.....14
 Home of the Month.....17
 Important Phone Numbers.....19
 JTCA Annual Picnic.....10
 JTCA Discussion List.....15
 JTCA Web Site.....15
 Monthly Meeting Minutes.....2
 Neighborhood Cleanup Days...12
 Newsletter Articles.....18
 Nominating Committee info...13
 Officers and Board Members..19
 Raheb Health Info.....16
 Science Center news.....9
 Walter Fuller Center news....8

The next JTCA Meeting is scheduled for Monday, January 17th., Social 6:45PM, Meeting 7:00PM
 The meeting will be held at the Walter Fuller Youth Center, 7891 26th. Ave. N., St. Petersburg.

On the Agenda

- ◆ National Income Tax & Accounting
- ◆ Karl Nurse 2005 CONA President
- ◆ Jungle Terrace 2005 Elections



Karl Nurse, 2005 President, Council of Neighborhood Associations will be our guest speaker.

Garage Sale

Saturday, February 26, 2005,
 8AM to 12PM,
 Walter Fuller Center

Browse for values or rent a table for \$5.00 and sell your used items.

Call Brad Rice
 for table rental at
 893-7443.



Jungle Terrace 2005 Activity Schedule

- ◆ Saturday February 26 8AM to 12PM
Garage Sale with Walter Fuller Teen Group
- ◆ Saturday March 26, Easter Egg Hunt 9AM-10AM
Pictures with Easter Bunny and Face painting.
10:00AM Easter Egg Hunt.
- ◆ Monday April 18 Monthly meeting at Sunken Garden.
Free to members. Speaker Mary Campbell with tour of Gardens. 7PM to 9PM.
- ◆ Saturday April 23 Sunday April 24 Green Thumb Festival
Walter Fuller Park.
- ◆ Saturday October 8, 8:30AM to 11:00AM, Pets in the Park
with a blessing of the animals. Walter Fuller Dog Park.
- ◆ Saturday November 5, 11:00AM to 2:00PM Jungle Terrace
Picnic with Bluegrass Music. Walter Fuller Park
Pavilion.

Annual Membership Dues Due in January page 3



Mike Krautkremer's Lawn Maintenance

Residential/Commercial
Licensed and Insured
Landscape Services

- Mow
- Edge
- Trim
- Hedges
- Mulch
- Honest
- Dependable



Free Estimates
Call (727) 647-0794
**Your Neighborhood
Lawn Service**

Minutes of the November 15, 2004 Monthly Membership Meeting

A regular monthly meeting of the Jungle Terrace Civic Association was held on 15th day of November 2004 at the Walter Fuller Youth Center. The meeting was called to order by President Killian at 7:00 PM following a social time with refreshments. He then led the Pledge of Allegiance. There were 34 people and 1 dog present.

- ◆ Minutes: The minutes, as reported in the newsletter, were approved by motion duly made and seconded.
- ◆ Treasurer's Report: **Skip Mitchell** read a detailed treasurers report. The report was filed for audit.
- ◆ Safety: Officer **Rich Hladik** reported there had been a couple of armed robberies and that the perpetrators had been caught. There had also been a lot of auto robberies, mostly taking contents. He advised everyone to keep their car doors locked. In answer to who was doing the robberies in the neighborhood, Officer Hladik responded they were mostly juvenile boyfriend/girlfriends, etc. He said the only other type robberies were those types which occur in gas stations and parking lots. He reported that due to a hand full of kids they were going to do a lot of home visits making sure probation was being observed, etc. as this did reduce the robberies in the past. He said he might have to start doing these himself. Ron Russell said he heard police were instructed not to write tickets for handicapped parking violations at, for instance Tyrone Mall. The Officer agreed that they don't, mostly, because there were not enough police on the street. Ron said he met with the Tyrone Mall security people recently and they told him to call the non-emergency police number and report when they see violations. It was brought out that there is an organization of elderly people who patrol handicapped spaces and report violations. Officer Hladik told the group there are only two officers at the mall and they are on shifts and handle everything, including as many as 10 arrests a day for shoplifting. A female attendee reported a hole had recently been cut in her vinyl siding then **Bob Miller** noted that auto thieves tried to break into his vehicle just while he was inside a business. Officer Hladik stated that putting a club on your car is the best deterrent. A member asked about restrictions for registered pedophiles. It was reported that they do have restrictions in distance from schools and other places where children gather. He said he visits the one in Jungle Terrace, but that sexual offenders are different and there are several of them in the neighborhood.
- ◆ Nominating Committee Report: **Steve Plice**, Chairman of the Nominating Committee for 2005, announced the other members of the committee were Ed Carlson and Mary Scott. He then reported the following nominations: President, **Tom Killian**; Vice President, **Ron Russell**; Secretary, **Lyn Dexter**; Treasurer, **Linda Mouriski** and for Board members: **Bob Miller**, **Skip Mitchell** and **Larry Dosh** (member of the City Beautiful Committee of St. Petersburg). It was asked that it be made known to the voters whether the nominees are homeowners and/or business owners. The chairman stated he thought it was good to have a business owner on the board. The election will be held during the January membership meeting and at that time nominations from the floor will be entertained.
- ◆ Redevelopment proposal for the former Joann's Fabrics were discussed at length. **Steve Plice** reported he and **Tom Killian** had met with the developer and they want to expand the present building by

(Continued on page 6)

Grand opening!

Tiny Tykes Wide selection of Children's clothing,
Maternity, School Uniforms,
Baby necessities and Toys.



Consignment, Inc.

6574 Central Ave.
(on the corner of 66th St. & Central)

727-343-4020

*Mention this ad and
receive a free gift!*

Art Stone COMPANY INC.

Orchids



MICHAEL J. POLEN
PAULA J. POLEN
Seedlings to Blooming
All Potting Supplies

3611 Tyrone Blvd.
St. Petersburg
Florida 33710
(813) 345-6733

Rolls-Royce JAGUAR CHRYSLER Ford VOLVO



**Bill GRAMLEY'S
AUTOMOTIVE**
347-7676
JAGUAR - MERCEDES
BMW - VOLVO - ROLLS-ROYCE
EUROPEAN DOMESTIC JAPANESE

AAA APPROVED
QUALITY WORK
AT A FAIR PRICE

**Extended Warranty
Service & Repair
Foreign & Domestic**

SUV's *Pickup Trucks*



3984 Tyrone Blvd. N., St. Petersburg, Fl. 33709

HONDA Mercedes-Benz GM BMW TOYOTA

2005 Tyrone Square Lifestyle Redevelopment Announcement

Join us in celebrating the announcement of the lifestyle redevelopment plan.

Wednesday, January 12, 2005, Sears Court

8:30 AM Continental Breakfast

9:00 AM Announcement Ceremony

Please RSVP by January 10th

(727) 345-0126

TYRONE SQUARE

SIMON HALLS | more choices™





Your Neighborhood Tax Professionals



**Helping Individuals,
Businesses, Estates & Trusts
Since 1985**

When it comes to having your income taxes prepared and filed, choose National Income Tax & Accounting, Inc.

Our approach is simple: offer professional, personalized service at reasonable prices.

Professional

At National Income Tax your taxes will be prepared by a tax Professional. Tom & Karen Gargiulo are Enrolled to Practice before the I.R.S. For more informationa about E.A.'s, please go to our website www.nationalincometax.com.

Personalized

You will receive a personalized appointment in a private office. No waiting. No impersonal cubicles.

Reasonable

Our pricing is affordable and often less than our competitors. Call for a quote.

Tax Preparation

- Individuals
- Sole Proprietors
- Partnerships
- Corporations
- Estates
- Trusts



**\$ 10.00 Off
Tax Preparation**
new clients only

**Free E-Filing
\$ 40.00 Values**
with tax prep

**\$ 25.00 Off
Business Tax Prep**
new clients only

**Refund
Anticipation Loans**
from **\$ 89.00**

Conveniently located at
2952 66th St N

Call for an appointment
345-7790

www.nationalincometax.com



REALTY EXECUTIVES



KC Jones Broker-Vice President

Realty Executives
4020 Park St. N.
St. Petersburg, FL. 33709

Cell: 727-458-5263
Business: 727-347-1000
Fax: 727-345-6969



Kenneth City Beauty
3 bedroom 2 bath with
1326 htd. sf. Immaculate
condition with white
cabinets and new
appliances. New windows
and Cent. H & A. Screen
enclosed porch overlooks
large corner oak shaded lot.
Ample room
for boat or RV.
\$169,000



Sold Properties in the Jungle since November 14, 2004

Address	bedrooms /bath	Square footage	listed Price	Days on Market
7218 34th Ave N.	3/1	864	\$112,000.00	35
8104 26 Ave N.	2/1	938	\$129,900.00	82
8621 Park St N.	3/1	1018	\$139,800.00	1
7961 22 Ave N.	2/1.5	1224	\$149,900.00	1
3074 70 Lane N.	3/1	1632	\$159,900.00	94
1214 76 St N.	3/1.5	1518	\$159,900.00	69
8008 Boca Ciega Dr	3/2	1182	\$164,900.00	42
6760 29 Ave N.	2/2	1084	\$174,000.00	19
8069 27 Ave N.	2/2	1322	\$179,900.00	49
2701 66 Way N.	3/2	1572	\$179,900.00	128
8200 30 Ave N.	3/2	1644	\$200,000.00	1
8128 24 Ave N.	3/2	1476	\$204,900.00	6
7678 31 Ave N	3/2	1464	\$229,000.00	1

The sold prices have not been included to protect the privacy of the Buyers. Please call for additional information. The information sited in this ad is obtained from the MLS system, Realtors, owners, and the public records. The properties have been listed and sold by various participants in the MLS System.



Orange lake village

2 bedroom 1 bath in original condition. window unit air, oil heat, jalousie windows. Inside laundry room, water conditioner, pump and well for water the lawn. Carport and storage sheds. **\$99,900.**

*104 properties sold in Jungle Terrace in 2004.
This reflects the area from 22 Ave N. to 38th Ave
N. and from 66 St to the Bay. The average
selling price was \$174,341 based on an average
of 1338 SF.*

That makes our price per square foot \$130.!!!

Realty Executives your Local Real Estate Company



Specializing in:

- Pain Disorders
- Neck Back, Shoulder Pain
- Trauma Injuries
- Arthritis
- Fibromyalgia/CFS
- Migraines
- GYN Disorders
- Menopause Disorders
- Natural Hormone Replacement
- Digestive Disorders
- Stress/ Anxiety
- Acute/Chronic Disorders
- General Practice

Services Available

- Acupuncture/Acupressure
- Electro-Acupuncture
- Eclectic Stimulation (TENS)
- TuiNa Massage Therapy
- Herbal/Bionutrient Therapy
- Systemic Detoxification
- Infrared Heat
- Vacuum Cupping
- Dietary/Lifestyle Counseling
- Self-Healing Techniques
- Monthly Wellness Programs
- Discount Programs
- Weight Loss Programs

Andrea Guttveg, LAc, AP

**Board Certified Acupuncture
Physician**

and Oriental Medicine

PIP Auto Ins. Accepted



Patricia Medical Center
220 Patricia Ave.
Dunedin, FL 34698
3775 Central Ave.
St. Petersburg, FL 33713

Phone: (727) 736-9191
Cell: (727) 458-6207
Fax: (727) 736-8991

(Continued from page 2)

adding a home furnishing store to it and build two separate out buildings for fast food restaurants. The developer changed the plan, but still didn't meet the code. They have expanded an area where they will save some of the trees, however 25% of the land is supposed to be undeveloped permeable land and they are still be over about 10% and asking for variance. If the parking was made permeable we probably would approved that. He said the enlargement was towards Bob Evans and buildings are proposed for where the trees are. The developer is also asking for landscape and septic variances too. **Ron Russell** stated he thought it had been decided years ago to take a hard stance as far as green space is concerned. A parking variance is requested too, they are about 40 under. This would only hurt them, as people won't be parking in neighborhood. They are only 8000 sq. ft. short on permeable area out of the total project that includes 250,000 square feet. **Rich Meredith** recommended we approve if they agree to his motion, seconded by **Ron Russell**, that JTCA not object provided either they meet the code or put in permeable parking to the percentage required (per perk, that is to say sufficient area to allow for the same amount of percolation as the required percentage of permeable land) to meet code. Motion passed unanimously.

◆ There will be a CONA Committee on Wednesday, November 17 and they will talk about utility lines. **Steve Plice** said we are suggesting they bury lines and indeed they are burying utility lines for new installations or when lines have to be replaced. He stated at that rate it would be 100 years before they are all buried. He said another Leadership course was coming up and to see him if interested. Jungle Terrace will pay the \$69.

◆ Program: Your Real Estate Taxes: **Jim Smith**, Pinellas County Property Appraiser was introduced. He suggested that instead of the 40 min speech, do something different...have the audience ask questions. When die during year Homestead still applies next year. The other people with Mr. Smith were introduced as **Rick Matanna**, and another man introduced as Herb. Ad valorem is the best of all worlds in Florida. We revalue every year and inspect every 3 years. You get notice in August. We'd like residents to come in to the office early in year if you have concerns regarding the valuation of your home. He said he had 160 employees. 217 lawsuits were inherited from his predecessor, mostly for small changes he has instructed his people to make on their own. He stated he had been in business prior to running for office and that he ran his office like a business. Tax increases are limited to 3% maximum per year on home value, but when there is a change of ownership then the new price is used. He thinks after January 1st the seller has to reveal this. Taxes are based on sales in the neighborhood. Mr. Smith was commended for updating their web page frequently, by a member who told him we do appreciate it. Flood zone definitions and criteria was noted not to be available on the website however, Mr. Smith said he believed they could add the elevation in feet. FNIP maps issued in 1982 are the basis for post or pre-firm for this area and St. Petersburg has them. It was noted that Homestead Exemption allows an addition \$500 for widows/widowers, as well as disabled and blind persons. Disabled veterans meeting the criteria are exempted an additional \$5000. These must be filed for by March 1st. Mr. Smith stated there were 13 multi-family, 2473 single family with 30 vacant, of the 186 commercial spaces, 13 are vacant. Residential sales in Jungle Terrace in 2001 were 114, In 2002 there were 137 sales, in 2003 the number was 123, and in 2004 162 real estate sales. Vari-

(Continued on page 7)

Christ United Methodist Church
467 First Avenue North
St. Petersburg, FL 33701
727-833-3343
E-mail: cumcsp@cumcsp.org
Website: cumc.happychurches.com
Traditional Worship: 8:30 am
Contemporary Worship: 9:00 am
Celebrative Worship: 10:45 am
Pastor: Rev. Tom Norton, Jr.

Science Center
Of Pinellas County, Inc.
7701 22nd Avenue North, St. Petersburg 33710
Phone: (727) 384-0027
www.sciencecenterofpinellas.com
Monday-Friday 9 a.m.-4 p.m., Saturday 10 a.m.-4 p.m.
Saturdays \$5/Person, Special Shows & Exhibits
for the whole family!
Classes & Workshops for Pre-K through 12th Grade!



(Continued from page 6)

ous home value categories were stated including that in the \$500,000 to 1 million category there are 58 homes and in the over a million there are 8. Three maps were displayed which illustrated county values up/down, sales, and value.

- ◆ Program: Society for the Prevention of Cruelty to Animals: **Amy Edwards & Pogo** were introduced by President Killian. She is a volunteer in Education Dept. Pogo participated in the JTCA's recent Pets In The Park event and won the award for "Longest distance to attend". Ms. Edwards informed the group she had adopted Pogo from the SPCA and that they have all types of animals. Pogo did some tricks for the group and allowed anyone interested to pet him. She said every year we get 17,000 in our shelter alone and a number through thru donations (by people who simply don't want their pets any longer). The SPCA's membership fee is only \$15/sr. member. They have a store at Seminole Mall that sells toys etc., and they have a newsletter. Brochures were made available during the meeting. They have 10 acres, and have a horse, geese, and so on, which will retire there. We are an open admission shelter, we take every animal that comes to us as a relinquishment or sick/hurt only, not strays. She said they counsel prospective adopters. There is a two-week summer camp for kids 12-15. Volunteers give talks to schools and youth groups, and group such as Jungle Terrace. Ms. Edwards reported that 40% of children who commit school violence first did animal cruelty. Eighty-two percent of men who practice domestic violence on women have seen animal cruelty in their house. Adults or children can call SPCA to report cruelty or possible cruelty to animals, such calls are anonymous. Calls are investigated. Call if have pet behavior issues and get counseling and obedience classes are offered. Only thirty percent of the animals available for adoption are on the website. The SPCA investigates over 3000 cruelty cases/year. Organized dog fighting is a problem in the area, and such dogs cannot be adopted. Gangs are using dogs such as pit bulls for intimidation.
- ◆ Picnic Report: President Killian reported that 150 people and at least three dogs attended the picnic, here on the grounds, on Saturday, November 6th. He thanked everyone who helped to make the event a success and he also thanked those who attended.
- ◆ Newsletter: **Bob Miller** asked for suggestions for articles for newspaper. He was praised for the wonderful article on the mobile home park.

The meeting was adjourned by general consent at 8:49PM.

Toni Miller, Temporary Secretary

A special thanks to Toni for her help with this months minutes!



The Plumber that offers you a choice!
Call us today and
EXPERIENCE THE DIFFERENCE

Water heaters - Water Conditioners
Water filters - Remodeling
Six months same as cash
(727) 526-7600
www.stpeteplumbing.com

Proud member of 

MAIL BOX EXPRESS

3993 Tyrone Blvd., #608
At Walmart Plaza



St. Petersburg, FL. 33709

Mon - Fri, 9 a.m. - 5:30 p.m.

Sat 9 a.m. - 4 p.m.

Phone (727) 384-2811

Fax (727) 384-2712

*For all your packaging
Office & Small Business Needs.*

15% Off **Coupon**
Your first U.P.S. Shipment **GROUND**

Remember, once you get over the hill, you'll begin to pick up speed.

AWN TECH

~Factory Direct~

Canvas or Vinyl



Commercial & Residential

*Let Us Design Something
Unique For You!*

727-528-3918



Azalea Branch Library News

Teen Programs

Teen Scene

Every Thursday
6:30pm - 8pm

Adult Programs

Book Discussions

Always call for time and date (727-893-7930)

Children's Programs

Mother Goose : (infants - 3 years)

Tuesdays and Wednesdays 11:00am

Preschool Story Time: (ages 3-5)

Tuesdays and Wednesdays 10:00am

"Family Storytelling Night"

1st Thursday of every month at 7:00.
We tell stories for all ages and do a related craft.

Azalea Branch

7801 22nd Ave N

St Petersburg, FL. 33710

Mon, Wed, Fri, Sat 9am - 6pm

Tue, Thur 9am - 9pm

727-893-7930

by Donarita Vocca



A little girl had just finished her first week of school. "I'm just wasting my time," she said to her mother. "I can't read, I can't write and they won't let me talk!"



Walter Fuller Center News

Walter Fuller Recreation Center

7891 26 Avenue North
St. Petersburg Florida 33710
(727)893-7443



Monthly Fee Classes

Children -----

	Day	Start Time	Cost (per month)
Basketball, Instructional	Sat	11:00am	\$20
Baton	Wed	5:30pm	\$19
Cheerleading	Thurs	4:00pm	\$16
Gymnastics	Thurs	4:45pm	\$15
Tae Kwon Do	Mon & Wed	5:30pm	\$35

Adult -----

Exercise with			
Rita	Mon & Wed	6:30pm	\$12
Tae Kwon Do	Mon & Wed	6:30pm	\$35
Yoga	Tues & Thurs	6:30pm	\$32



by Brad Rice

EAGLES NEST RESIDENTS, INC.

7801 34TH Ave North
St Petersburg FL 33710

Phone & Fax (727) 347-7909
Resident owned Mobile Home Community
Age 55 and over RV'S WELCOME
rental and sales of mobiles



TAXI



(727) 367-3702

www.BatsTaxi.com

Fax 367-8354

P.O. Box 66330 • St. Pete Beach, FL 33736

ELECTRONIC FILING
REFUND LOANS IN 24 HRS.

TAX RETURNS FROM
INVOICES & RECEIPTS



THE TAX GUY, INC.

Guy Bickerstaff, E.A.
(727) 343-1398
(727) 521-2765

CELL (727) 418-6488
2401 72ND ST. N.
ST PETERSBURG, FL 33710

FAX (727) 343-1398
BOOKKEEPING &
INCORPORATIONS



The Science Center of Pinellas County

**New Exhibit-"The Veterinary
Office" opens on
Super Saturday, Jan. 15.**



**Play vet, learn CPR for your pet, enjoy a circus
style dog act.**

Call the Science Center at (727) 384-0027 for times and details!

The Science Center is a unique learning environment for children through adults that offers hands-on educational activities to promote the understanding of science. Over 70,000 visitors of all ages take part each year in special programs, lectures, exhibits and events!



What have you been missing?

- Spirit of Columbia Theater & Planetarium.
- 600-Gallon Marine Touch Tank .
- 16th Century Indian Village.
- Live Animal Room.
- Fun Laser Shows
- African American Inventions Exhibit.
- Fall, Spring & Summer Workshops .
- Customized Birthday Parties
- Presentations for Girl & Boy Scouts.
- Monthly Evening Events for Families .
- Fun Festivals



The Science Center is open:

Monday-Friday 9 a.m.-4 p.m.

Admission: \$1 / Person, for self-tour.

Saturday 10 a.m.-4 p.m.

Admission: \$5 / Person includes all shows, exhibits & special programs. The gift shop is open during the hours above. Also, Gift Certificates for Super Saturdays and Memberships are available. Please look in the paper and check our Web Site

sciencecenterofpinellas.com

by Marie Stempinski

PICNIC PAVILION

The new picnic pavilion is complete. This area is open to the public on a first come first served basis. The only exception to this is when Walter Fuller Playcamp is in session and the children are eating lunch or snack.



Serenity Pools, Inc

Specializing in Quality Remodels
and New Construction



**Kim Bingham
(727) 224-9961**

Office: (727) 345-8996
Fax: (727) 343-2295

Rick & Kim Bingham
Owners/Operators
State Lic. #CPC1456564



Life, Annuities,
LTC, Health
Return on Premium Life

John G. Conklin
Consultant

Laake Financial Services, Inc.

1070 Kapp Drive • Clearwater, FL 33765

Phone: 727-443-4571 ext. 213

Fax: 727-447-2405

E-Mail: johnglenn36@hotmail.com

Serving All
Insurance
Needs



Mark Pelham

Store Director

ALBERTSONS INC. 3900 66TH. STREET NORTH
SAINT PETERSBURG, FLORIDA 33709
727-381-4312 FAX 727-381-6324



Aida's Beauty Salon

*** Hair Care ***

7233 Central Avenue

St. Petersburg, FL.

By Appt. or

727-302-0096

Walkins welcome

Jungle Terrace 2004 Annual Picnic

By: Tom Killian

On Saturday November 6th. we held our Annual Picnic under the new outside pavilion at Walter Fuller Park. One hundred and fifty members attended on a beautiful day. The food was provide by Albertson's, one of our advertisers in our newsletter. We want to thank their manager **Mark Pelham** and Albertson's for their generous support of our association. Please support them by purchasing food from Albertson's.



Emily and Jim Lipe enjoy the festivities.



Our newsletter folding crew, **Yaro Markewycz** and **Barbara Hinkens** enjoying the picnic.

We also want to thank Mattress Firm and their manager **Mike Peck** for their generous donation of a Queen Size bed and pillows for our raffle. If you need bedding please support Mattress firm. The bed was won by **Dr. Jeff Raheb** another advertiser in our newsletter.

Bob Miller ,our Award winning newsletter editor, brought his Bluegrass group to entertain the membership. **Richard Meredith** was our Chef and his wife **Carolyn** helped during the rush period. Everyone who attended received a free raffle ticket for

SAFFRON'S

AT HISTORIC JUNGLE PRADA *Caribbean Cuisine*

- FINE DINING
- OUTDOOR DINING
- EXPRESS CATERING
- BANQUET FACILITIES
- TAKE OUT

1700 PARK STREET N.
ST. PETERSBURG, FL 33710
727-345-6400

MON-THURS 11AM-9:30PM
FRI & SAT 11AM-10PM
SUN 2PM-10PM • BRUNCH 11AM-2PM

There is always something happening at saffron's!

WWW.SAFFRONSCUISINE.COM

Sponsors Needed!

If you live in the Jungle Terrace neighborhood and own a local business, we need your help to sponsor your neighborhood newsletter, the official monthly publication of the Jungle Terrace Civic Association. Our rates are reasonable and our newsletter reaches people in your area that can purchase your service.

Business Card Size ad	\$45.00 a year
¼ Page Ad	\$115.00 a year
½ Page Ad	\$225.00 a year
Full Page Ad	\$450.00 a year
You supply full page (8.5 x 11) insert	
.....	\$30.00 for one month

Please call Tom Killian, 343-2041, and I will be glad to tell you how our newsletter can help you increase your business.

prizes. Dan's Hauling donated a free dumpster hauling. **Dr. Jeff Raheb** donated two full body massages. Officer **Rich Hladik** and the St. Petersburg Police Department donated automobile clubs. Many other free prizes were given out.

I want to thank all the people who helped set up the picnic and everyone who brought a covered dish for helping make it a great success. We plan to have another picnic at the same location on Saturday November 5, 2005.



Good food and a very good turnout made this years picnic a big success.



Entertainment was provided by the bluegrass music group, Mountain Memories.

Apple Dental Group



Dr. Phillip Apple
 Dr. Richard Edwards
 Periodontist
 Dr. Terryl Crawford
 Endodontist
 6759 First Avenue South
 St. Petersburg, FL. 33707
727-381-1642 Fax 727-384-0764
 Apple Dental Affiliates, PA

**Heather Pillion
 Janice Kaplan
 Owners**



- Grooming
- Barkery
- Natural Pet Products & Supplies

tel: 727.345.8118
 6840 22nd Ave. N. St. Petersburg, FL 33710
 e-mail: bathnbiscuits.com@verizon.net

Vet Recommended



Discovery Learning Center At PARC

Caring for and educating children of all abilities since 1953

M-F 7am-6pm
 Lic. #C680083
 We accept CCC

- Credentialed Teachers / Experienced staff
- Nurse on staff
- Small Classes
- Toddler Computer Lab
- Toilet Training / Independent self-care skills
- Trained to work with special needs
- On-site therapy (PT, OT, Speech, Behavior)

Day Care / Early Intervention / Before & After School / Pre-K / Summer Camp
3100 75th St. N. 727-345-9111
 www.discoverylearning.org



“Neighborhood Cleanup Days”



February 14th and **February 28th** are designated Neighborhood Cleanup Days in the Jungle Terrace Neighborhood. The City will provide trucks to pick up those hard to discard items like old furniture, appliances, carpeting, yard waste, limbs (up to 4 feet long), and junk from the garage. This is a free pickup.

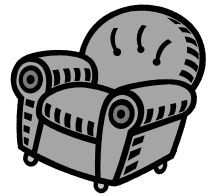

The cleanup will proceed as follows. For those residents on the East side of Tyrone Blvd, you must put your cleanup items **at your curb on February 14th at 7:00 am.** The city will provide trucks to pick up your items. If all the items can't be picked up on February 14th, pickup will continue on the day/s that follow until completed but the items must be put **at the curb on February 14th at 7:00 am.**

For those residents that live West of Tyrone Blvd, this process will start on **February 28th at 7:00 am.**

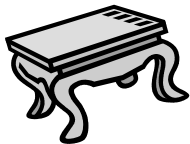

The City's Sanitation Department **WILL NOT** pick up hazardous wastes (paint, solvents, pesticides, etc), junk cars or building materials.

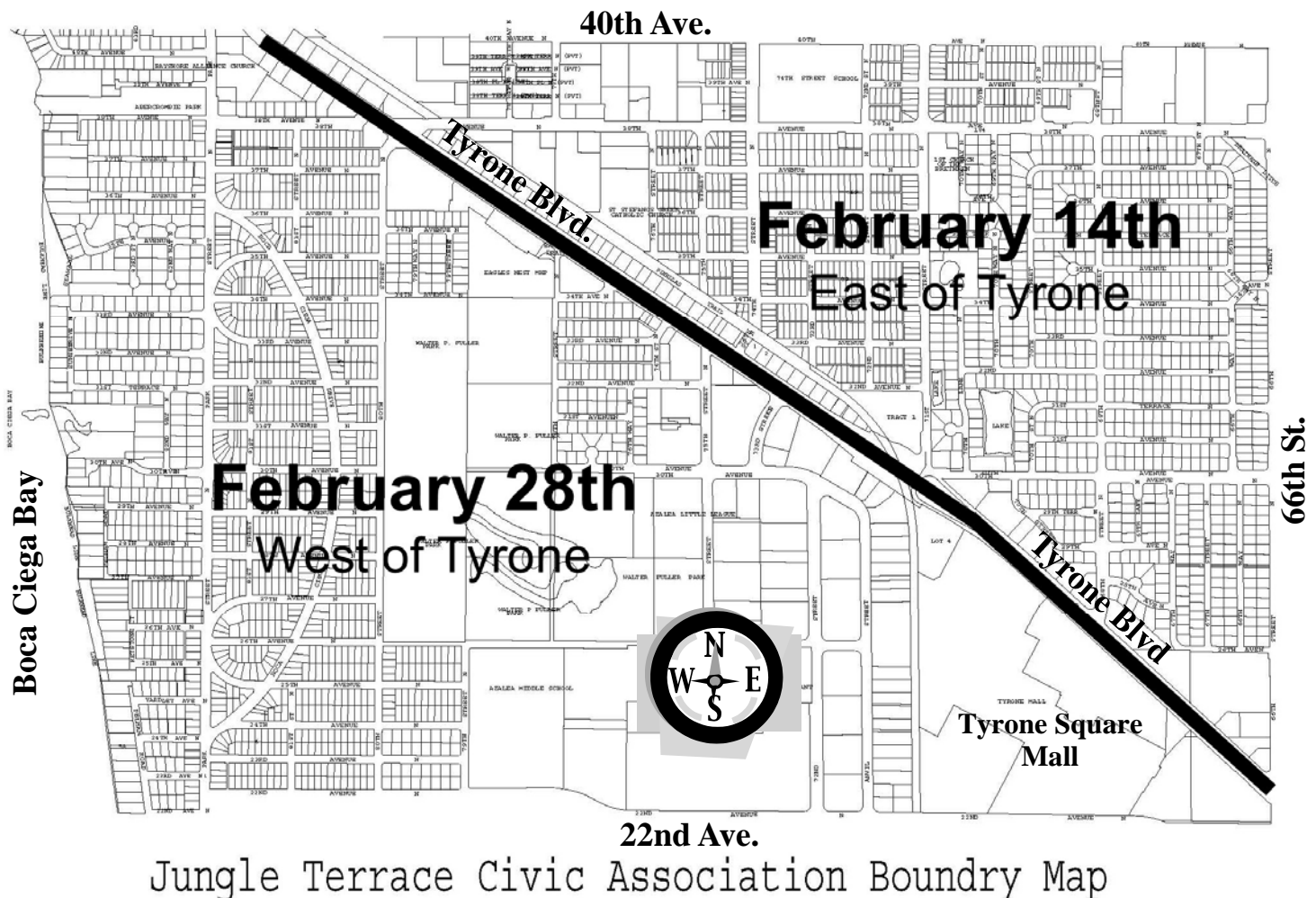

Jungle Terrace Civic Association Boundary Map

Johnny Leverock's St. Pete Beach

We would like to thank the local community for 20 years of support at this location.

We are still serving all of the great recipes that the Leverock Family taught us in 1980.

We have stuck with the basic principles that Johnny Leverock had in 1948.

- Fresh Local Fish • Famous Clam Chowder •
 - Delicious homemade Pies •
- like our Peanut Butter or Key Lime Pies
all made right in our kitchen.*



Sincerely,
George Lewis, John Stross & Vanessa Parnell
Owners Since 1984

P.S. ~ Don't forget our Sweeping Water Views!

🐟 10 Corey Avenue, St. Pete Beach 🐟 727-367-4588 🐟

Tyrone Square Update

We are happy to begin providing the Jungle Terrace community with monthly updates on the activities happening at Tyrone Square via your fine newsletter.

Be sure to see our invitation included in the newsletter (Page 3) to a special lifestyle redevelopment announcement ceremony on January 12.

We are striving every day to improve the quality of Tyrone Square to be the best shopping experience in the Tampa Bay area. Here are just a few of the improvements in progress at Tyrone Square.

Over the next few weeks, you will notice the addition of bicycle racks and motorcycle parking areas at each mall entrance. In addition, the handicap parking areas will be restriped creating additional handicap parking, regular parking and Expectant Mother parking spaces.

Here are some of the recent merchant enhancements that have taken place over the past several weeks:

- **Cache** underwent an extensive renovation and has unveiled their newest store design concept in the Tampa Bay area at Tyrone Square.
- **Limited Too** opened in their new location next to Lynn's Hallmark
- **Blue Wireless/Cingular** has upgraded to a new kiosk in their location in front of Champs
- **VIP Wireless/Verizon** has also upgraded to a new kiosk

located in front of Bond Jewelers

- **Pandemonium** opened in the Dillard's concourse with unique lighting, cards and trendy / novelty gifts
- **Toyopia**, "The Ultimate Toy Store Experience", opened next to Spencer Gifts.

These merchants are under construction and /or will be relocating to their new locations by February 1:

- **Champs** is building a new exciting store and will be relocating to their new location next to Kirklands
- **Regis** is under construction in their new location a few stores closer to Sears
- **Rave** will be relocating to their brand new store next to the Disney Store
- **Pants Towne** is moving near JCPenney next to Lenscrafters
- **Victoria's Secret** will be relocating to a temporary location near JCPenney next to Deck the Walls while their new prototype store is under construction .

In an effort to provide you more convenient shopping hours, we are extended our mall hours on Sundays starting on Sunday, January 2, 2005. Tyrone Square will now be open every Sunday from 11:00am - 7:00pm. We are pleased to be

(Continued on page 19)



Winter Plant Care

by Dean Miner

Owner *Floridian Pest & Turf Management*

See ad page 19



ANNUALS:

Now that the cold weather is here winter annuals such as petunias, salvia, pansies, snapdragons, sweet alyssum and calendulas will begin to grow and flower. Don't forget to fertilize at least once a month with dry fertilizer. If you use a soluble fertilizer, apply at least twice a week.

CITRUS:

Several problems may confront your citrus tree. Oranges may be brown instead of a bright orange. This is caused by rust mites, a tiny insect that sucks the juices from the cells of the skin. Their feeding causes the fruit to turn brown. It is too late to protect the fruit with a miticide now. Spraying should be done earlier in the year. Apply a miticide for use on citrus in June -July and a second treatment should be made October-November.

HOLIDAY PLANTS:

Christmas cactus and poinsettias should have special care, especially watering. The soil in which these plants are grown is a mix that drains very well and dries very quickly. Poinsettias will loose all of their leaves if they dry out, even the slightest amount.

LAWNS:

The warm weather has created some problems with the grass. Weeds are growing more luxuriant than they did during the summer months. There is still time to use a weed killer on the St. Augustine. **USE EXTREME CAUTION WITH HERBICIDES.** They will kill the weeds but can also kill the lawn. If you have planted rye grass avoid using weed killer on the lawn, the herbicides will kill the rye grass.

MANGOS:

A light application of fertilizer this month will help the tree. Check all trees for scale insects and spray if necessary. Watch for aphids on any blooms of new growth. Use neutral copper or Dithane M-45 on the blooms stalks before they open for control of anthracnose fungus.

PITTOSPORUM:

Cercospora leaf spot will be a problem throughout the winter months. It appears as a light yellow spot on the leaves and attacks the leaf in between the veins. Use neutral copper or Dithane M-45 on a monthly basis.

QUESTION & ANSWER

1. We have an oak tree that doesn't look healthy. There are some dead limbs with bunches of growth that look like balls of grass. What is the problem and is the grassy growth killing my tree?

What you are seeing is "ball moss" which is actually a form of bromeliad. It lives off substance from the air. It does not kill the tree but merely uses it for support. You can see it growing on the utility wires. Apparently, the tree is under some form of stress.

Send you questions to the newsletter and I will answer a couple each month.

mail questions to...

Bob Miller
8215 30th Ave N
St Petersburg, FL.33710

or e-mail questions to BluegrassBob@earthlink.net



Additional Seating Added

By: **Tom Killian**

The Jungle Terrace Civic Association requested and received from the city two additional benches for our small Dog Park. Pictured here are **Kay and Spence Gardella** and their Award Winning Chihuahua Hudson. Please join Hudson and his many friends who enjoy the dog park daily. The park is open seven days a week, free admission. Located at 80th. Street North and 30th. Avenue North.

Mountain Memories

Traditional Bluegrass Music



Pete Lissman Guitar (727) 536-8508
Bob Miller Banjo (727) 343-4436
 E-mail—Bluegrassbob@earthlink.net

Bluegrass music
for all occasions

Repair Service **Free Estimates**

Pressure Washer Rental Tools/Equipment Rental

AFFORDABLE MOWERS

Quality Work & Reasonable Prices
 (727) 347-3103

Bill Domante, Owner
 3800 58th Street North
 St. Petersburg, FL 33709



Jungle Terrace Web Site

We have a web site for the Jungle Terrace Civic Association. It is at URL www.JungleTerrace.org. It is available for viewing to anyone that has internet access. The web site has important organizational information, a Neighborhood map, the soft-copy Newsletter and much more. The Newsletter and map are in PDF format. If you don't have the Adobe PDF reader you can download it free at www.adobe.com Look for this button



Questions contact Webmaster Bob Miller at BluegrassBob@earthlink.net



The Jungle Terrace Internet Discussion List

Jungle Terrace has an Internet discussion list that is available to all neighborhood residents free. If you have a computer you can join. Learn what is happening today. Don't wait until the next meeting or until you receive your next newsletter. When you sign onto the list, you can then participate in discussions concerning things that are important to our neighborhood. Help us solve problems and make our neighborhood the best in the city. To join the list, send an e-mail to Steve Plice at steveplice@verizon.net



KR FRITZ

- **Designs & Drafting**
- **Residential Addition & Renovation Construction Plans**
- **Ready to Permit & Build**
- **Ideal for Homeowner Contractor or Outside Contractor**
- **Construction Consulting**

384-4331

Mention this ad for a \$50 Discount

Before they invented drawing boards, what did they go back to?

January 2005

Astrological Sign: Capricorn (December 21 - January 20) and Aquarius (January 20 - February 18)

Flower of the Month: Carnation

Birthstone: Garnet

	Last Quarter	3rd	12:46 p.m.	1st	New Years Day
	New Moon	10th	7:03 a.m.	17th	M.L. King Birthday
	First Quarter	17th	1:57 a.m.		
	Full Moon	25th	5:32 a.m.		

February 2005

Astrological Sign: Aquarius (January 20 - February 18) and Pisces (February 18 - March 20)

Flower of the Month: Violets

Birthstone: Amethyst

	Last Quarter	2nd	2:27 a.m.	2nd	Groundhog Day
	New Moon	8th	5:28 p.m.	9th	Ash Wednesday
	First Quarter	15th	7:16 p.m.	21st	Presidents Day
	Full Moon	23rd	11:54 p.m.		



(727) 344-1604

Extra Closet

100% Air Conditioned Storage

KEN & BOB
Managers

2401 Anvil Street N.
St. Petersburg, FL 33710

DAN'S HAULING, INC.

Mary Lombardi / Treasurer
8110 30th Ave. N., St. Pete, FL 33710
(727) 341-1135 • Fax (727) 381-1114



WE HAUL ANYTHING!

- Construction Sites
- Demo Work
- Garage Clean-Outs
- Yard Clean-Ups
- Drop Off Service
- 12 Cu Yard
- Same Day Svc.
- Free Estimates



Neighborhood Sign Painting



Jungle Terrace Civic Association president, **Tom Killian**, paints the lettering on our neighborhood signs located between the Science Center and the Azalea Middle school library. The original gold paint had faded some so Tom has touched up several signs located around the neighborhood.

RAHEB Family Chiropractic



Dr. Jeffrey Raheb

Chiropractor

Wellness • Injury • Accident

Se Habla Español
Children • Medicare

6701 - 38th Avenue N., Suite B-1
St. Petersburg, FL 33710

Office: (727) 381-3456 • Cell: (727) 692-0643 • Fax: (727) 381-3762

Finding Answers to Your Health

No matter what our state of health may be, there is probably a way to improve it. Most times these positive changes will focus on the body's ability to heal itself.

Chiropractic is based on the natural laws of how the body functions and heals. Doctors of chiropractic look to the spinal column for misaligned vertebrae (subluxations) that hinder proper nerve flow. Restricted nerve transmission reduces the communication between the brain and the rest of the body. For example, when a "kink" in a water hose restricts the flow of water, the flower garden suffers and flowers may eventually wilt and die from lack of water.

In a similar fashion, parts of the body can slowly deteriorate when the life force in the body is reduced because of misaligned vertebrae. This can happen to anyone at any age. If subluxated vertebrae (misaligned spinal bones) remain uncorrected, health problems may surface. Sometimes the problem may appear suddenly; however, in most cases, the difficulty was really brewing for some time. For example, in spinal bones and joints where only certain bones have become arthritic and have degenerated, other adjoining bones may not have the same problems. Many times people are told the arthritic joints result from old age, yet all the joints (including those that are not diseased) are the same age. If arthritis is a function of old age, why aren't all the joints affected?

The answer to this question may lie in a healthy nerve supply, which helps to keep the bone or joint healthy. The sooner we seek chiropractic care to detect and correct such problems, the greater chance we will have to experience a healthy, pain-free life. No matter what our current health condition may be, chiropractic care can enable our bodies to reach their maximum potential for health.

Contrary to the misconceptions of some people, chiropractic care is a gentle, natural and non-invasive method for detecting and treating health problems and for maintaining wellness. In contrast, thousand of people die year from every medical procedures and drugs. Chiropractic care is a natural form of health care offering lasting results without the risk of dangerous side effects.

We give thanks and we acknowledge our grateful appreciation for the natural, wholesome approach of chiropractic, which helps us give the best to our children, family and friends.

Natural chiropractic care can help with: headaches, low back pain, whip lash from auto injuries, asthma, allergies, carpal tunnel syndrome and neck stiffness and pain.

(Taken from Health News & Views November 2002)

Sponsors Needed!

If you live in the Jungle Terrace neighborhood and own a local business, we need your help to sponsor your neighborhood newsletter, the official monthly publication of the Jungle Terrace Civic Association.

Our rates are reasonable and our newsletter reaches people in your area that can purchase your service.

Business Card Size ad	\$45.00 a year
¼ Page Ad	\$115.00 a year
½ Page Ad	\$225.00 a year
Full Page Ad	\$450.00 a year
You supply full page (8.5 x 11) insert	
.....\$30.00 for one month	

Please call Tom Killian, 343-2041, and I will be glad to tell you how our newsletter can help you increase your business.

FASTSIGNS®

Sign and Graphic Solutions

Made Simple.®

- Banners
- Vehicle Graphics
- Full Color Graphics
- Exhibits & Displays
- Safety & ID Signs

www.fastsigns.com



4058 Park Street - St. Petersburg

727-341-0084



Home of the Month by Linda Mouriski

This month's Neighborhood Pride Award goes to **Russ and Joyce Hinkley**. Their home is located at 7801 34th Ave. N. Lot # 20. The Hinkley's purchased the home in 1998, and have remodeled the interior as well as the exterior. They purchased in this area because they had friends nearby and enjoy the park. Russ and Joyce continue to love the area for its convenient location, the great neighbors and friendly atmosphere.

Congratulations Russ & Joyce.



Newsletter Articles

Do you have a letter, issue, article, or recipe you would like to publish in the JTCA newsletter? We welcome letters, comments, and contributions from our neighbors.

We would like to invite you to create articles that will inform our neighbors about items of interest relating to our neighborhood. Some suggested subjects are Pinellas Trail, Tyrone Corridor, Tyrone Square Mall, the Dog Park, Pool and Tennis Courts, Soccer League, Azalea Little League, Walter Fuller Park, the Devil Rays Complex, History of Abacrombie Park, our Linear Park 30th. Ave. N., the two schools in our area, Walter Fuller Center after renovations, Mobile home park on 34th. Ave, recipes, etc.

Photos are welcome. We can also take photos for your article. Articles and photos can be in soft-copy (preferred) or hard copy.

Send to; Bob Miller 8215 30th Ave N 343-4436
BluegrassBob@Earthlink.net

Article and Advertising Acceptance Policy

Articles will not be accepted which in any way is considered to be lacking in judicious good taste or moral propriety, or which demeans any particular race, language, religion, or political view. Articles of a controversial political nature will not be accepted. Advertising of a controversial political nature will not be accepted. Advertising found to contravene truth, exaggerate the description of a product or service, or containing fraudulent statements will not be accepted. Advertising is accepted with the conditional understanding that the sponsoring company and principal beneficiary of the advertisement is ultimately responsible and liable for its content. We reserve the right to reject or revise all copy submitted, or to cancel advertising at any time.

Mediation Specialists

Providing Dispute Resolution For the Commercial, Business & Residential Community.

We Specialize in Pre-Litigation Conflicts Regarding Consumer, Employee, Contract and Insurance Disputes. We offer Flexible Scheduling

Telephone: 727/345-7000

Cert# 01933R

Not a Law Firm

Stylecraft

Window Treatments, Inc.

501 - 9th STREET NORTH
 ST. PETERSBURG, FLORIDA 33701-2198
 PHONE 894-6858 • FAX 821-5566
 TOLL FREE 1-800-758-2759

Armand Theodore Joyal II
 Manager

DRAPERIES & BEDSPREADS
 VALANCES & TOP TREATMENTS
 VERTICAL & HORIZONTAL BLINDS
 MICRO & MINI & MID SIZE BLINDS
 SHUTTERS & 1" & 2" WOOD BLINDS
 DUETTE & CELLULAR SHADES
 FABRIC PLEATED SHADES
 UPHOLSTERY & WALLPAPER
 CARPET & FLOORING
 REPAIRS & ALTERATIONS

CFI MORTGAGE

a Division of CFIC Home Mortgage, Inc.
 Correspondent Lender

Your Neighborhood Mortgage Company
Purchase, Refinance, Debt Consolidation

- **Free** pre-approvals
- **No** Discount Points
- **No** Application Fee
- **Low, Low** Rates
- **FHA /VA /Conventional**
- **Programs for Credit Challenged Borrowers**

The One Call Worth Making...

100% Call **Rick Bull**
Financing Available **727-344-0683**



JTCA 2005 Board Of Directors

To Be Elected January 17th

Jungle Terrace Civic Association, Inc. elects it's entire Board of Directors at the January meeting each year. Board Members serve a one year term.

Our Bylaws require that a Nominating Committee recommend a slate of candidates for Board Positions at least 30 days before the election. This year, the Nominating Committee announced the recommended slate at our November Meeting. The proposed candidates are:

President: **Tom Killian**

Vice-President: **Ron Russell**

Secretary: **Lyn Dexter**

Treasurer: **Linda Mouriski**

Board Member: **Mary Lou Mitchell**

Board Member: **Larry Dosh**

Board Member: **Bob Miller**

In addition to a willingness to serve, the Nominating Committee also tried to encourage new people to get involved as leaders of the Association. The Committee also attempted to ensure that residents from all parts of our neighborhood are represented on the Board.

At our January 17th Meeting, the Nominating Committee will solicit additional nominations from the floor. After receiving any floor nominations, the Committee will conduct an election for our 2005 Board. This year's Nominating Committee included **Ed Carlson, Mary Scott** and **Steve Plice**.



Important Phone Numbers

Emergencies	911
Rich Hladik, Community Policing Officer	892-5952
Police (non-emergency)	893-7780
(CASA)	898-3671
City Council Office	893-7177
Codes (get a case number)	893-7373
Elderly Information	893-7101
Garbage Collection Inf.	893-7334
Graffiti	893-7394
Library (Azalea)	893-7930
Mayor's Action Center	893-7111
Mosquito Control	464-7503
PARC (Pinellas Assoc. for Retarded Children)	345-9111
Public Service Rep. (Susan Fuchs)	893-4137
Rodent Control	893-7360
Schools; 74th St. Elementary	893-2120
Azalea Elementary	893-2187
Azalea Middle	893-2606
Street Light Maintenance (CL & P)	1-800-228-8485
Tip Line	892-5000
Water & Sewer Problems	893-7761
Walter Fuller Center	893-7443
Walter Fuller Pool	893-7636
For a free smoke detector Or home inspection	893-7233

Mark Your Calendar 2005 Meeting Dates

January 17	February 21	March 21
April 18	May 16	June 20
July 18	August 15	September 19
October 17	November 21	December No Meeting

Social 6:45 P.M. Meeting 7:00 P.M.

(Continued from page 13)

the first major shopping center in the Tampa Bay area to offer these extended Sunday hours.

Stay tuned for more exciting announcements...we have many more great things in the works for Tyrone Square.

Until next month...Happy Shopping!

Tyrone Square Mall Management

For A Lush Green Beautiful Lawn and Pest Free Home

Certified Pest Control Operator
& Horticulturist on Staff



"Call Us
& Relax"



FLORIDIAN
PEST & TURF MANAGEMENT, INC.

- Lawn Spraying
- Fertilizing
- Weed Control
- Pest Control

RESIDENTIAL & COMMERCIAL
Professional Lawn Care & Pest Control

(727) 344-2407

Officers and Board Members

President	Tom Killian	343-2041
Vice President	Ron Russell	345-7000
Secretary	Lyn Dexter	345-7000
Treasurer	Mary Lou Mitchell	345-4408
Board Member	Mary Scott	384-1718
Board Member	Linda Mouriski	381-4845
Board Member	Emily Coeyman	347-7366

Committees

	{ BluegrassBob@Earthlink.net }
Newsletter Editor.....	{ Bob Miller 343-4436 }
Newsletter	Tom Killian 343-2041
Membership	Mary Lou Mitchell 345-4408
Traffic	Ron Russell 345-7000
Home of the month	Linda Mouriski 381-4845
CONA Report	Steve Plice 344-3120
Welcoming	Mary Scott 384-1718
	{ BluegrassBob@Earthlink.net }
WebMaster.....	{ Bob Miller 343-4436 }
Meeting Refreshments.....	Betsy Dosh 343-3070



Jungle Terrace Civic Association
Member: Council of Neighborhood Assoc.
2275 80th Street North
St. Petersburg, Florida 33710
E-Mail: tomkillian@juno.com

Forwarding Service Requested

PRSRT STD
U.S. POSTAGE PAID
St. Petersburg, FL
Permit No. 1084



HAPPY NEW YEAR

2005



2004 Year in Review

By: Tom Killian

I want to thank our officers and board members for their help in making 2004 a great success. Thanks to Bob Miller, our outstanding Newsletter Editor, and our newsletter crew for winning "Newsletter of the Year." Many thanks to our advertisers who support us and our dues paying supportive members. Listed below are some of our activities and accomplishments in 2004.

- ◆ January - worked with city to obtain new green fencing along 30th. Avenue N.
- ◆ **February** - Jungle Terrace Garage Sale with Walter Fuller Teen Group at Walter Fuller Park.
- ◆ **March** - Jungle Terrace Neighborhood Cleanup.
- ◆ **April** - Easter Egg Hunt sponsored by Jungle Terrace 125 Children attend.
Jungle Terrace host for Green Thumb Festival.
Jungle Terrace celebrates its 50TH. Anniversary Mayor Baker attends and proclaimed it Jungle Terrace day in St. Petersburg.
- ◆ **May** - Jungle Terrace requests and receives new sidewalk connecting Science Center with Raytheon along 22nd.

- Avenue N.
Jungle Terrace installs 04 Partnership Grant on 30th. Avenue N.
- JTCA Board member **Linda Mouriski** graduates from the CONA Neighborhood Leadership Program.
- ◆ **August** - The county installs overhead bridge at 38th. Avenue North for pedestrian safety while using Pinellas Trail.
Flowering Trees are installed in the Tyrone Industrial Park to improve its appearance.
- ◆ **October** - Jungle Terrace sponsors Pets in the Park at the Walter Fuller Dog Park.
Jungle Terrace wins 6 Awards at the Mayors 8th. Annual Partnership Awards. 1st. Place for Newsletter of the year.
- ◆ **November** - Terrace Picnic 150 members attend, live Blue grass Music.
- ◆ **December** - Jungle Terrace 05 Partnership Grant approved. 4 concrete monuments for our Industrial park.

COPYRIGHT NOTICE.

Clipart used in articles in this publication is from MS Publisher 2003 and the MS Office Online, Clipart and Media Site. Copyright © 2003 Microsoft Corporation, One Microsoft Way, Redmond, Washington 98052-6399 U.S.A. All rights reserved.